



We strive to ensure that our products are of the highest quality and free of manufacturing defects or missing parts. However, if you have any problems with your new product,

**DO NOT RETURN IT TO THE STORE,**

please contact us toll free @:

**1-888-996-2729**

**FAX: 1-866-873-3531**

**gameroom@escaladesports.com**

**Mailing Address: (Correspondence Only)**

Escalade Sports  
PO Box 889  
Evansville, Indiana 47706-0889

**Physical Location:**

Escalade Sports  
817 Maxwell Ave.  
Evansville, Indiana 47711

Please visit our Web site at:

**www.escaladesports.com**

Please have your model number when inquiring about parts.

When contacting Escalade Sports please provide your model number, date code (if applicable) and part number if requesting a replacement part. These numbers are located on the product, packaging, and this owners manual.

Your Model Number AL1200W/F

Date Code 2 - AL1200F- - SY

Purchase Date \_\_\_\_\_

PLEASE RETAIN THIS INSTRUCTION MANUAL FOR FUTURE REFERENCE

**IMPORTANT! READ EACH STEP  
IN THIS MANUAL BEFORE YOU  
BEGIN THE ASSEMBLY.**

**IMPORTANT!**

THE DRAWINGS IN THIS  
MANUAL MAY BE  
EXAGGERATED OR MODIFIED  
TO SHOW DETAILS.



## 72 INCH X - LEG LED AIR HOCKEY TABLE

### Tools Required:

Socket Head Wrench (Included)

Furniture Polish and Cloth

Carpenters Level

Phillips Screw Driver

4 pcs AA Batteries (Not Included), A/C Adapter (Included)

(AA Batteries are for store display use only)( A/C Adapter is for residential use only)

(4 pcs AAA Batteries for strikers-Not included)

**An electric screwdriver is helpful in assembly. However, please set at low torque and use extreme caution with an electric screwdriver because you could overtighten the hardware and strip the screws.**

## Assembly Tips

Make sure you understand the following tips before you begin to assemble your game table.

1. Start all bolts by hand before tightening.
2. Some drawings or images in this manual may not look exactly like your product. Please read and understand the text before starting each assembly step.
3. Assembly can be made both simpler and less timely by first unpacking all parts , and matching and organizing them to the Parts Identifier . This will greatly help you become familiar with the parts before and during assembly .
4. Some of this assembly can be made easier – by placing the parts and building the assembly on a pair of saw horses . A table can be used also as long as the top is well protected from any scratches that could occur. The table or saw horses would need to be structurally strong enough to support this weight.

## NOTICE :

**READ AND FOLLOW ALL ASSEMBLY, OPERATION, AND  
SAFETY INSTRUCTIONS CAREFULLY. AT LEAST TWO CAPABLE  
ADULTS ARE REQUIRED TO ASSEMBLE THIS GAME TABLE.**

## ! CAUTION :

**AT LEAST FOUR OR MORE CAPABLE ADULTS ARE REQUIRED TO  
LIFT AND ROTATE THIS GAME TABLE INTO PLAYING POSITION.  
DO NOT LEAN THE TABLE ON ITS LEGS AS THIS COULD DAMAGE THEM.**

## HARDWARE IDENTIFIER (To Scale)

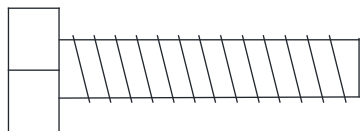

**H1 - 8mm x 40mm  
Hex Head Bolt  
(12 pcs)**

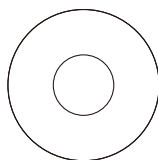

**H2 - M8 Flat Washer  
(16 pcs)**



**H3 - M8 Lock Washer  
(16PCS)**

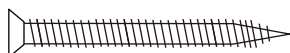

**H4 - 3.5 x 35mm  
Phillips Flat Head Screw  
(14 pcs)**

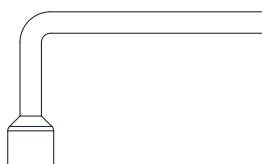

**(Not to Scale)**  
**T1 - Socket Head Wrench  
(1 pc)**

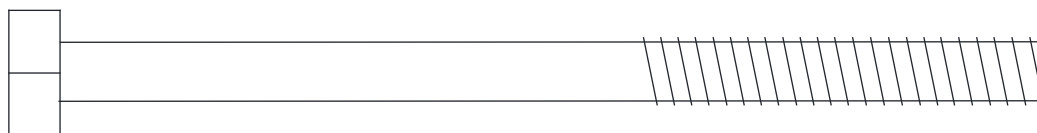

**H5 - 8mm x 130mm  
Hex Head Bolt  
(4pcs)**

## PARTS IDENTIFIER (Not to Scale)

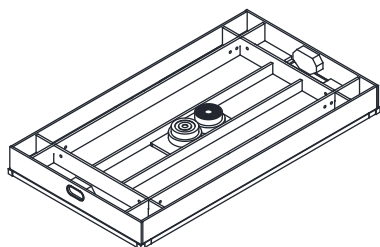

**P1 - Main Cabinet  
with Air Motor & Puck Catchers  
(1pc)**

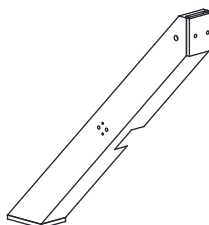

**P2 - Universal Leg  
(4pcs)**

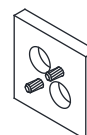

**P3 - Decorative Leg  
Wooden Block  
(2 pcs)**

Will assemble together

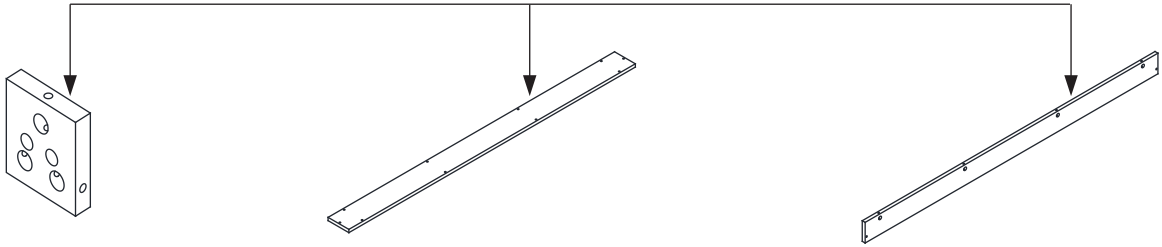

P4 - Wooden End Block  
(2 pcs)

P5 - Top Panel of Lower  
Center Support Beam  
(1 pc)

P6 - Side Panel of Lower  
Center Support Beam  
(2 pcs)

## ACCESSORIES IDENTIFIER (Not to Scale)

4 pcs AAA batteries  
will be required  
(not included)

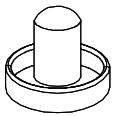

A1 - LED Striker  
(2 pcs)



A2 - LED Puck  
(1 pc)



A3 - Puck  
(1 pcs)



A4 - Felt Pad  
(2 pcs)

NOTE: A4 Felt Pads may already  
be attached to A1 Strikers

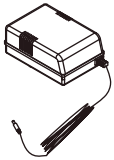

A5 - A/C Adapter  
(1 pc)

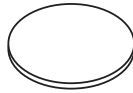

A6 - Table Leveling Shim  
(4 pcs)

Note: This equipment has been tested and found to comply with the limits for a Class B digital device, pursuant to part 15 of the FCC Rules. These limits are designed to provide reasonable protection against harmful interference in a residential installation. This equipment generates, uses and can radiate radio frequency energy and, if not installed and used in accordance with the instructions, may cause harmful interference to radio communications. However, there is no guarantee that interference will not occur in a particular installation. If this equipment does cause harmful interference to radio or television reception, which can be determined by turning the equipment off and on, the user is encouraged to try to correct the interference by one or more of the following measures:

- Reorient or relocate the receiving antenna.
- Increase the separation between the equipment and receiver.
- Connect the equipment into an outlet on a circuit different from that to which the receiver is connected.
- Consult the dealer or an experienced radio/TV technician for help.

This device complies with part 15 of the FCC Rules. Operation is subject to the following two conditions:  
(1) This device may not cause harmful interference, and (2) this device must accept any interference received, including interference that may cause undesired operation."

"CAUTION: Changes or modifications not expressly approved by the party responsible for compliance could void the user's authority to operate the equipment."

## PARTS REQUIRED

2pcs - **P4** End Block

1pc - **P5** Top Panel of Lower Center Support Beam

2pcs - **P6** Side Panel of Lower Center Support Beam

14pcs - **H4** Phillips Flat Head Screw

## STEP 1

Attach the **P4** End Blocks, onto the **P5** Top Panel of Lower Center Support Beam onto the **P6** Side Panels of Lower Center Support Beam using the **H4** Phillips Flat Head Screws as shown in **FIGURE 1**.

**Do not strip out the H4 screws.**

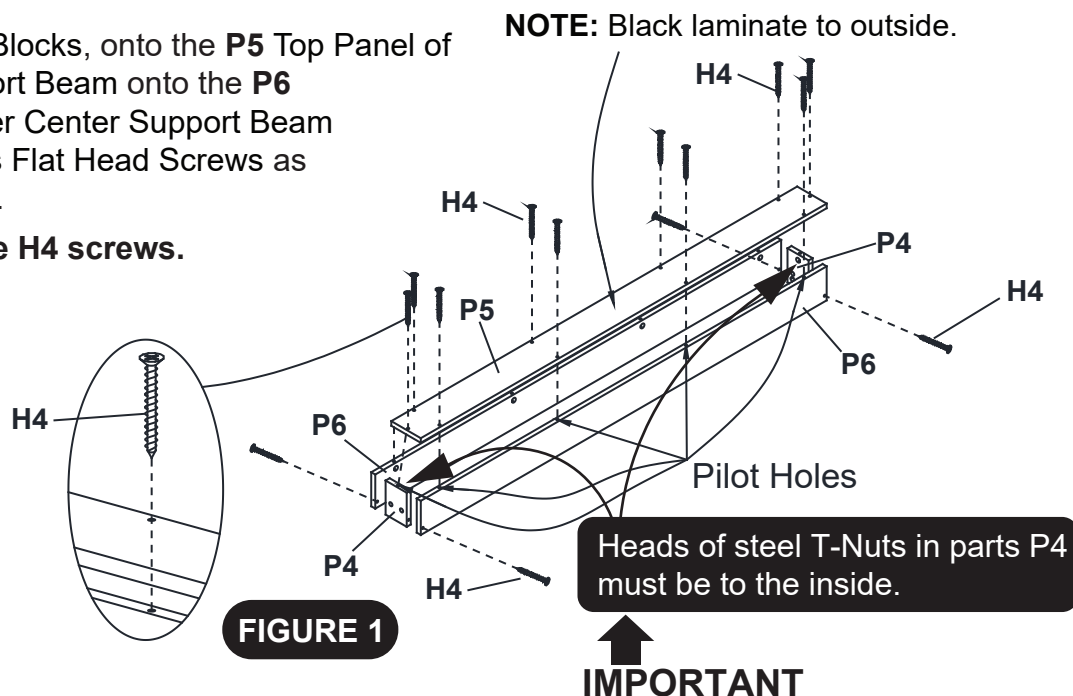

## PARTS REQUIRED (For Step 2 + Step 3)

4pcs - **P2** Universal Leg

1pc - **T1** Socket Head Wrench

4pcs - **H2** Flat Washer

4pcs - **H3** Lock Washer

4pcs - **H5** Hex Head Bolt

## STEP 2

Place together the four pcs of **P2** Universal Legs as shown in **FIGURE 2**.

Be careful watch for pinch points.

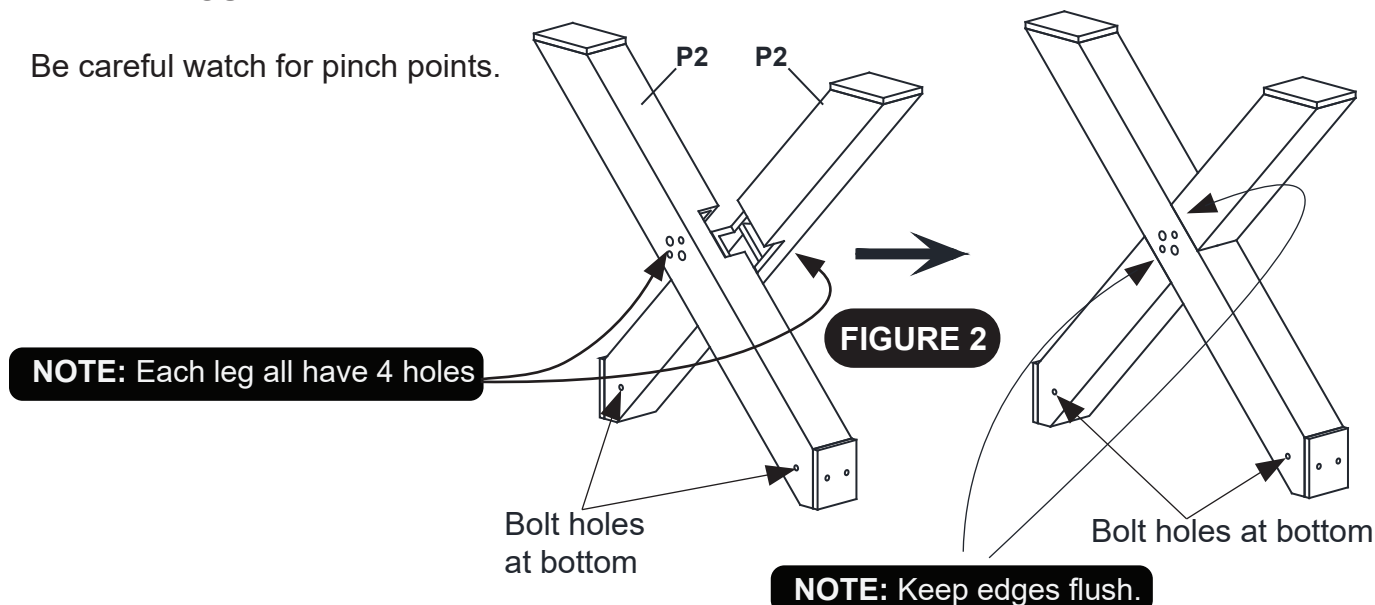

**IMPORTANT NOTE:** When “ Starting” any bolts within this table - use only minimal pressure as to not “ Push out” the inner “T” Nuts.

### STEP 3

With the help from another adult, attach the **Leg Support Beam** onto the “**X**” **Legs** using the **H5** Hex Head Bolts, **H2** Flat Washers and **H3** Lock Washers as shown in **FIGURE 3**.

**Only hand tighten all leg bolts at this time.**

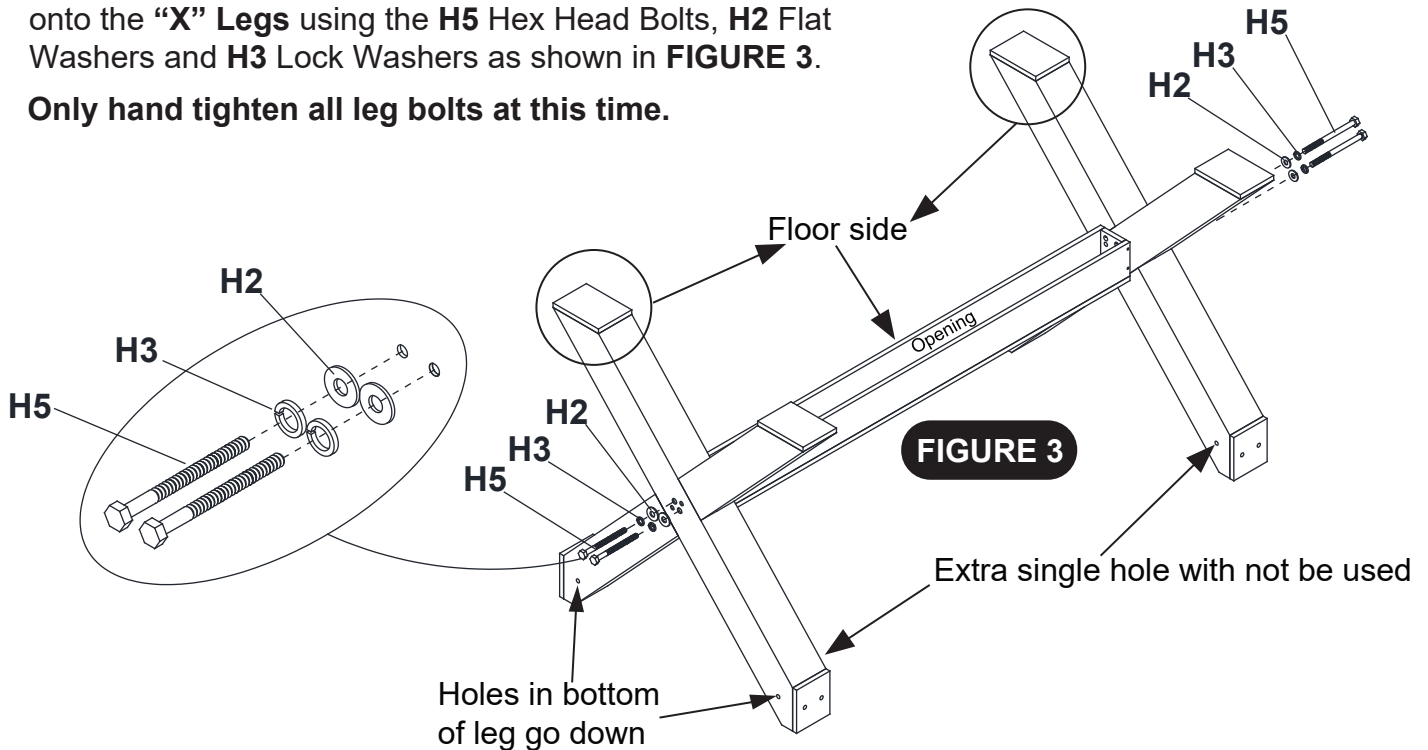

#### PARTS REQUIRED

1pc - **P1** Main Cabinet  
1pc - **T1** Socket Head Wrench

12pcs - **H1** Hex Head Bolt  
12pcs - **H2** Flat Washer  
12pcs - **H3** Lock Washer

### STEP 4

With the help from another adult, lift the **X** Leg assembly onto the **P1** Main Cabinet and attach using the **H1** Hex Head Bolts, **H2** Flat Washers and **H3** Lock Washers as shown in **FIGURE 4**.

**Tighten all bolts tight in this step and from Step 3 using the T1 Socket Head Wrench.**

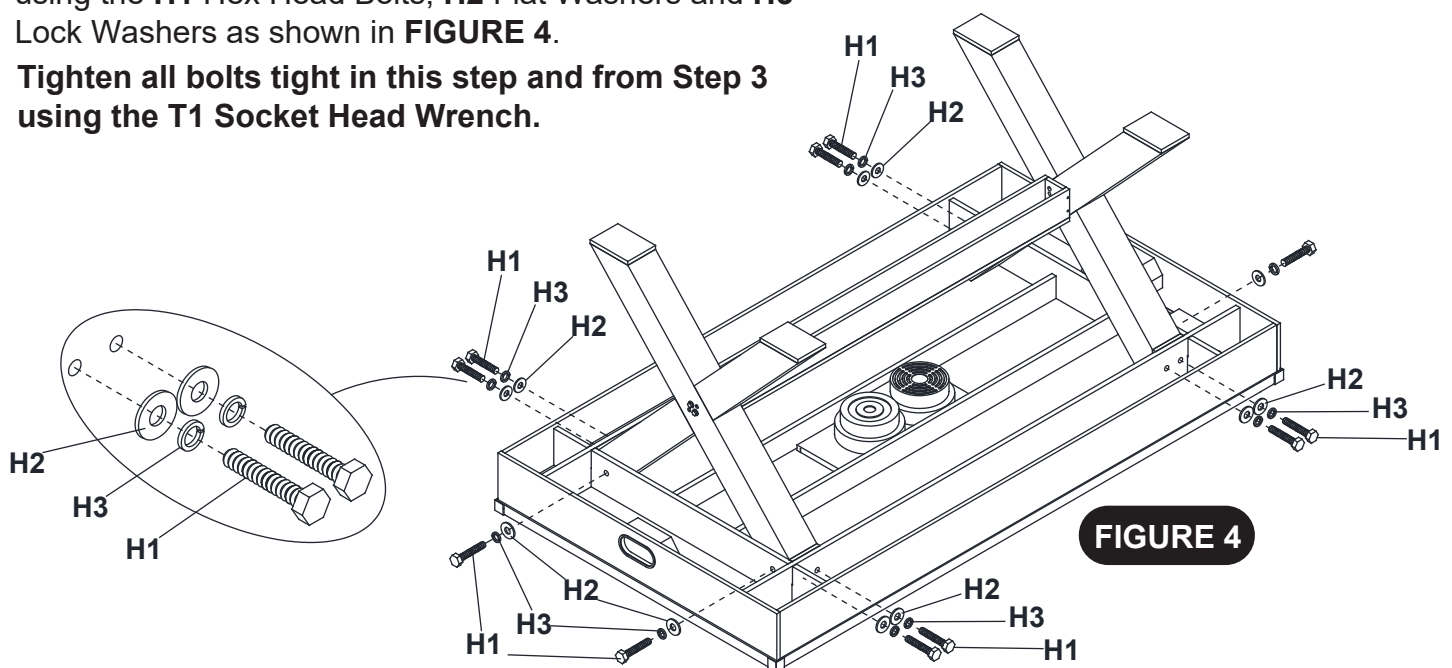

## PARTS REQUIRED

2pcs - **P3** Decorative Leg Wooden Block

### STEP 5

Insert the **P3** Decorative Leg Wooden Blocks into the "**X**" legs, as shown in **Figure 5**.  
A light tap from a rubber hammer may be required.

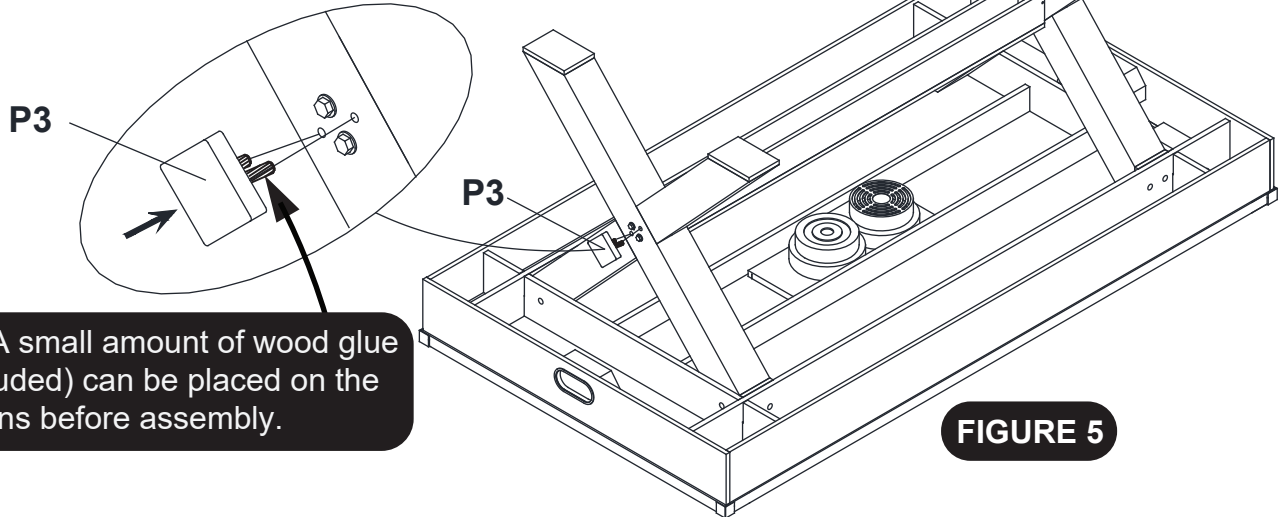

**NOTE:** A small amount of wood glue (not included) can be placed on the dowel pins before assembly.

### IMPORTANT NOTE for residential customers

**NOTE:** Before flipping the table - please check page 8 and locate where the A5 A/C adapter will plug into the Junction Box.

## LIFT + ROTATE THE TABLE

Always use proper lifting techniques

### ⚠ CAUTION :

AT LEAST FOUR OR MORE CAPABLE ADULTS ARE REQUIRED TO LIFT AND ROTATE THIS GAME TABLE INTO PLAYING POSITION. DO NOT LEAN THE TABLE ON ITS LEGS AS THIS COULD DAMAGE THEM.

### ⚠ CAUTION :

VERY CAREFULLY TURN THE TABLE OVER AND SET IT ON ITS LEGS. BE CAREFUL. THE TABLE IS VERY HEAVY.

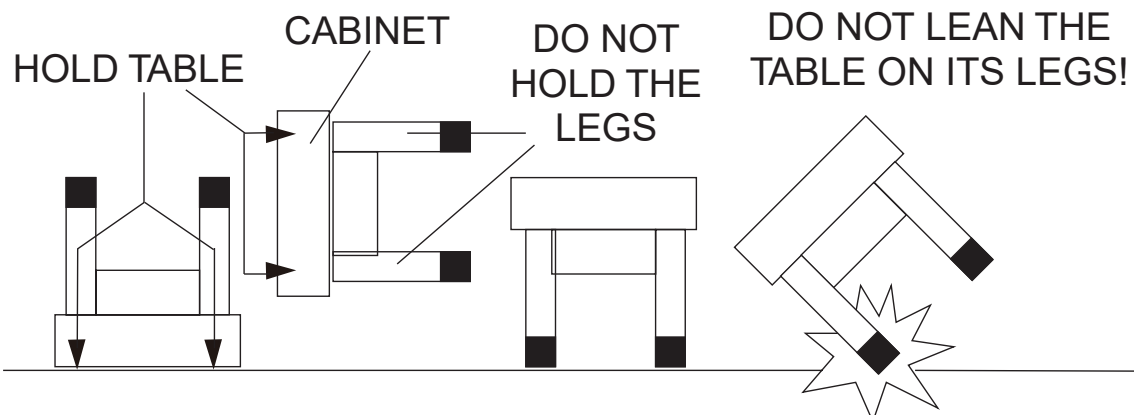



# ELECTRONIC CONNECTIONS

**NOTE:** This product has two power supply methods: battery and A/C adapter.

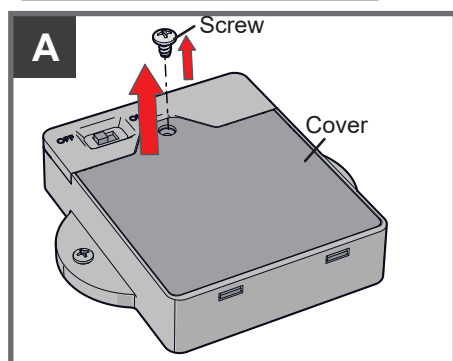
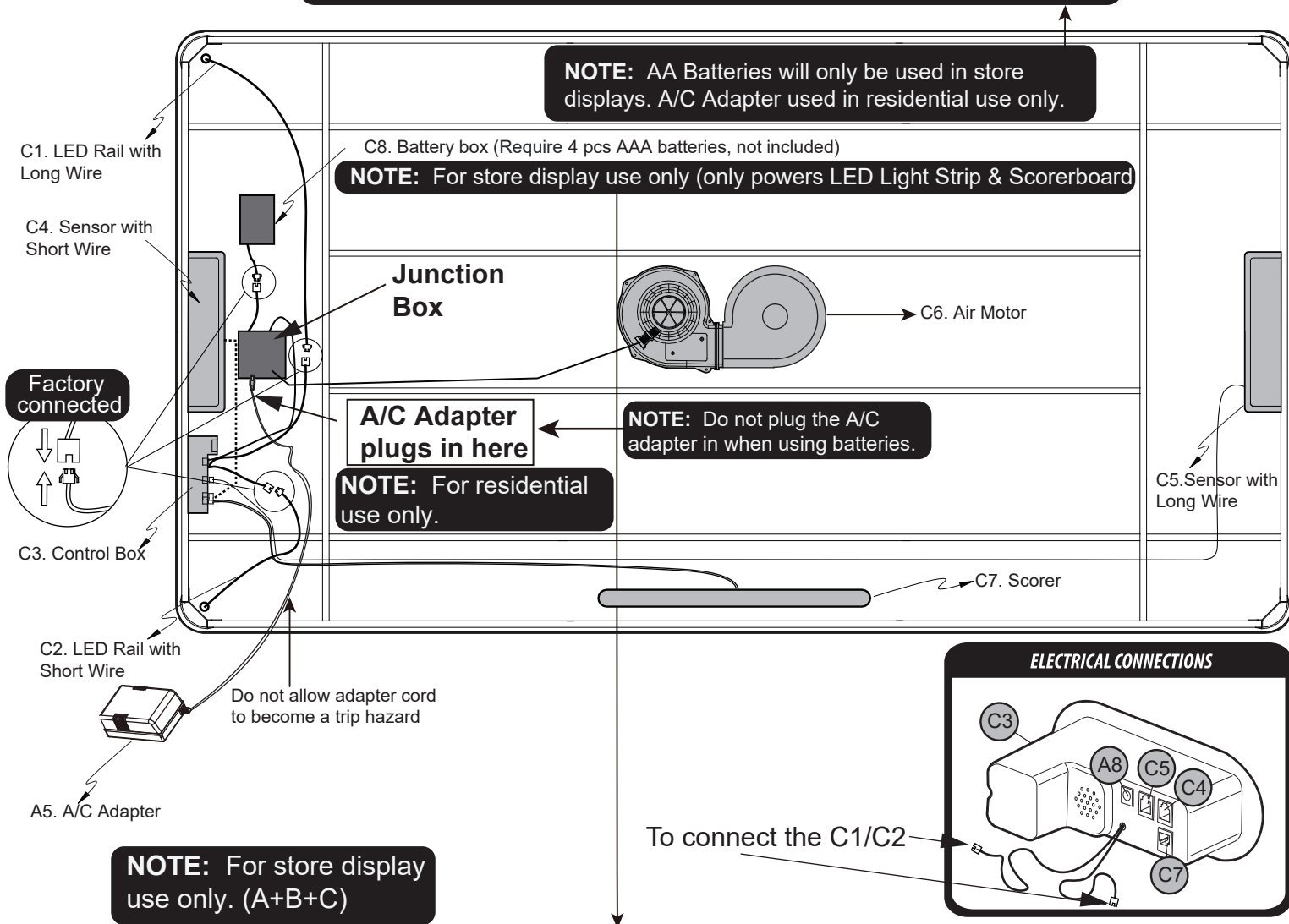

-Unscrew and remove cover.

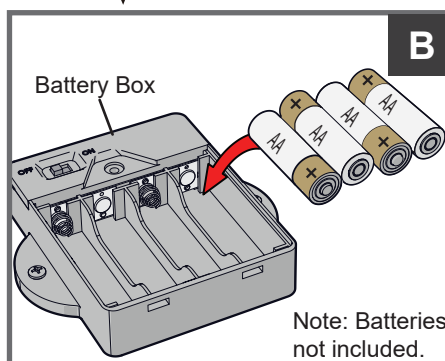

- Insert 4 AA Batteries (Batteries not included).

**Make sure polarity is correct.**

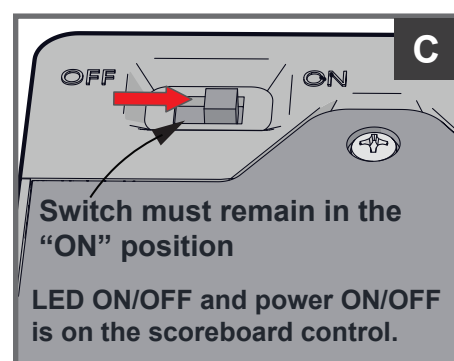

- Return cover and reinsert screw.

## (Store display use only)

Remove the small screw using a small phillips screwdriver and open the battery box, Insert (4) AA batteries (not included) in the order of correct polarity as shown on the inside of the battery box. Then close using the same screwdriver. (If the game will not be used for a long period of the time, we recommend that the batteries be removed)

See "FIRST TIME BATTERY INSTALLATION AND NOTICE", before installing batteries, located on **page 13**.



## **IMPORTANT NOTE TO OUR VALUED RETAIL CUSTOMERS AND STORE MANAGERS**

### **Valued Customers:**

This product will be powered in your homes with the A/C adapter only.  
The battery pack will not be used or needed in your home environment.  
It is simply not needed.

**DO NOT USE THE BATTERY PACK !**

### **Store Manager:**

For display reasons, a battery pack and directions for use are included with this product and in the assembly manual. Please note that the battery pack will only power the LED playfield lights and electronic scoring. The air fan motor will not be powered by the sole battery pack.

Do not plug the A/C adapter into the Junction Box when using batteries.

**Thanks all for your understanding.**

# Replacement of LED Light Strip(s)

## STEP ONE :

Should the LED lights not be working in the rail - Firstly , make sure the A/C Adapter is plugged in to a live A/C outlet properly. Secondly , make sure the A/C Adapter (**A5**) is tightly plugged into Junction Box outlet under the table . Lastly, make sure all LED Rail light connections are snugly plugged into the Control Box (**C3**) . At this point, if the LED Rail Lights still not be working , please disconnect the A/C power to the table before proceeding .

**A call will be required to our Customer Service Department to acquire the necessary replacement part(s).**

## STEP TWO :

If the LED Light Strip needs to be replaced on the **P1** Cabinet inner side, **carefully pry the C9 LED Strip Cover out of the apron with the help of a flat blade screwdriver as shown in DETAIL A**, then remove the C1 & C2 LED Light Strip from the table.

The LED Light Wire Connection will need to be disconnected first , the connection is under the table , please see page 8 .

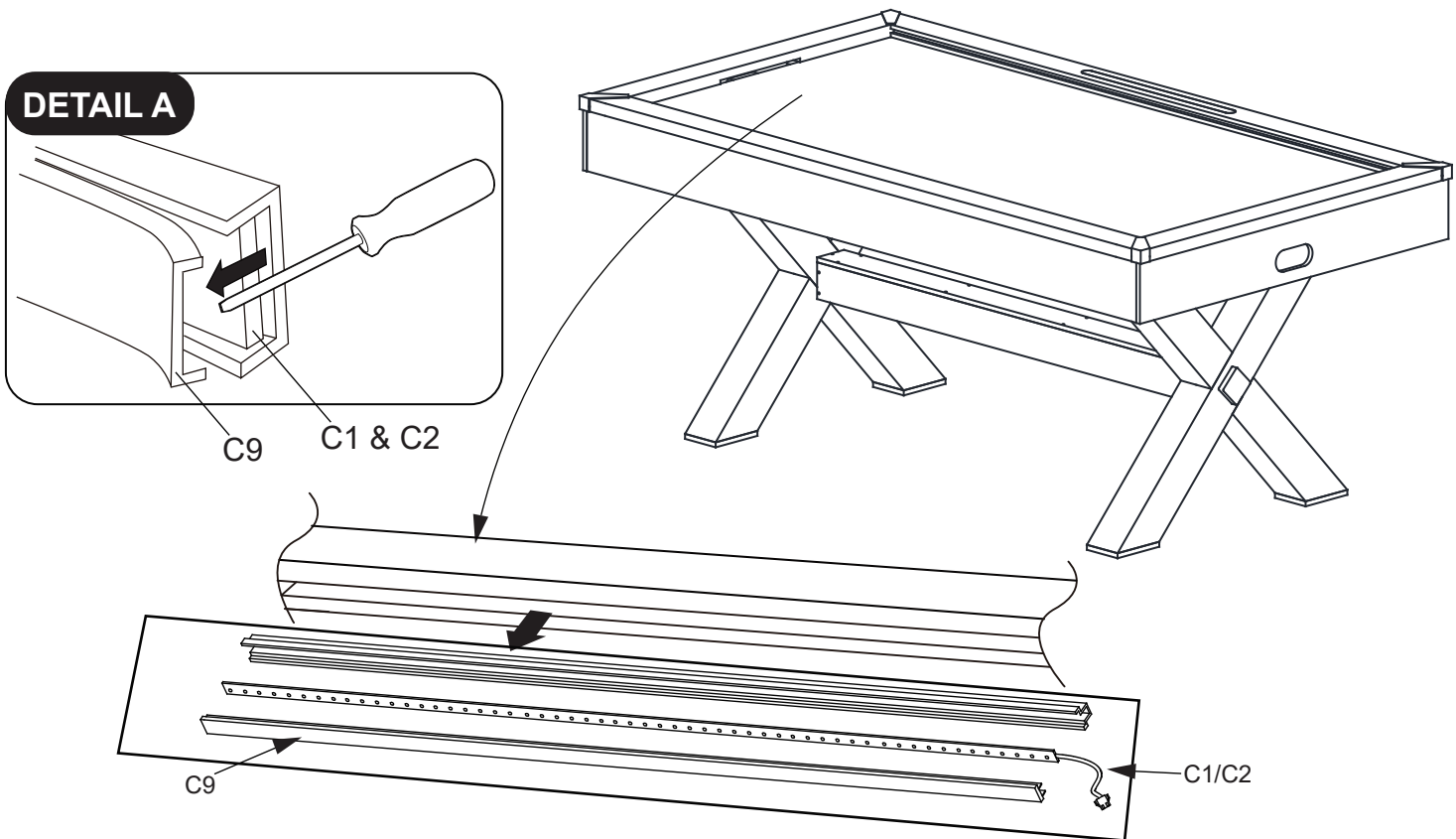

## STEP THREE:

Install the replacement LED Strip **C1 & C2** back to the Cabinet Side Rail. Align the male and female connectors of the Lighting LED Strip. Connect the plug of **C1 & C2** Lighting LED Strip with **C3** Control Box Wire.

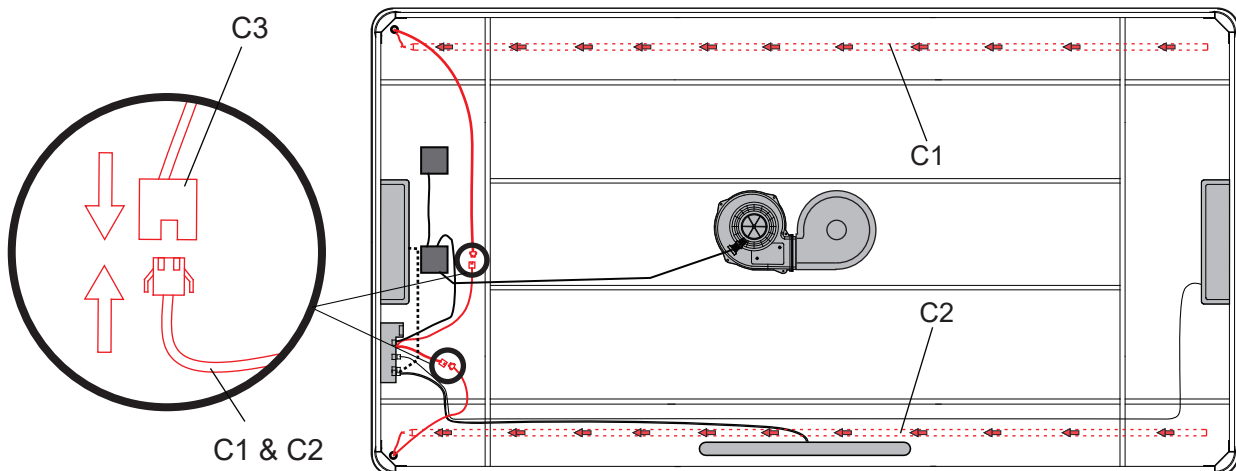

# SCOREBOARD CONTROL PANEL OPERATION

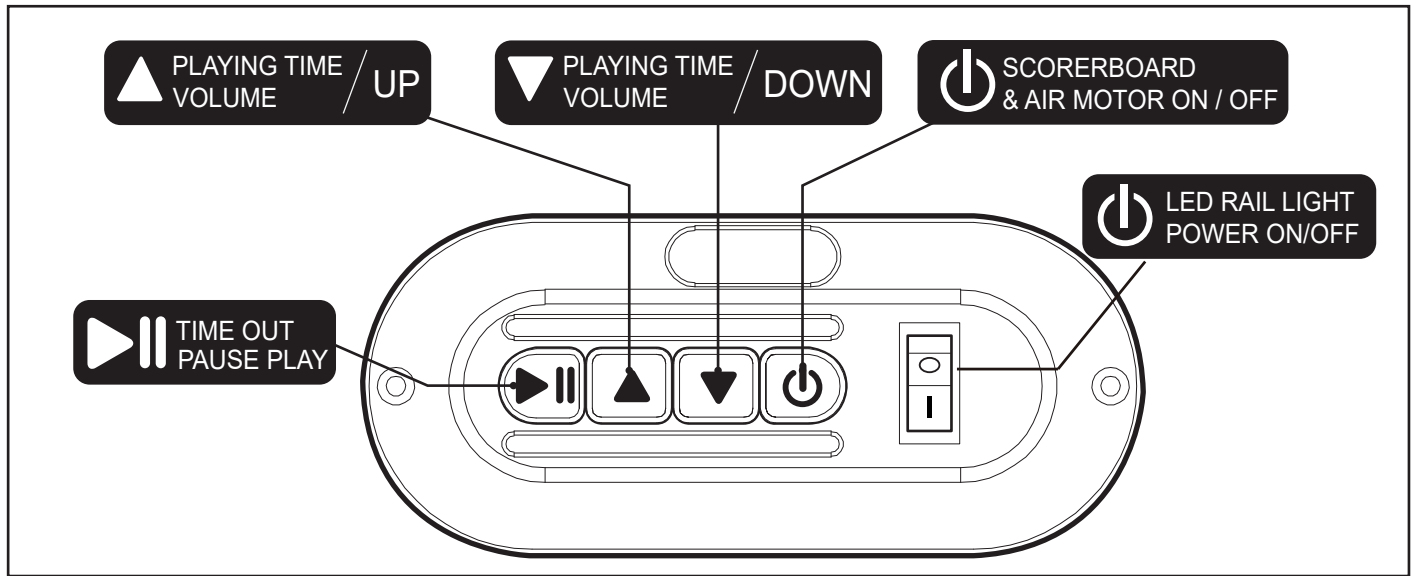

## SCOREBOARD CONTROL PANEL OPERATION

### SCOREBOARD POWER

Press the POWER button (⏻) to turn the scoreboard and air motor ON

### LED RAIL LIGHT POWER

Press the POWER button (⏻) to turn the rail light ON

### SELECT PLAYING TIME

Press the UP ▲ or DOWN ▼ button to scroll through the playing time options.

- 3 Minutes
- 5 Minutes
- 7 Minutes
- 10 Minutes
- Tug of War (Each goal scored moves the LEDs towards the scoring player. First player to reach 11 wins!)
- Free Play (no time limit)

Press the PLAY button ▶|| to select the current time and begin playing the game.

### SOUND

During game play, press the UP ▲ or DOWN ▼ buttons to adjust the volume level.

### TIMEOUT

Press the PLAY button ▶|| during game play to pause the clock and take a timeout.

### RESET

After the game is over, press any button (Except the POWER BUTTON) to RESET the scoreboard.

Press and hold any button (Except the POWER BUTTON) for 3 seconds to RESET the scorer at any time.

**This Control Box does have an automatic turn off feature after twenty minutes of inactivity (Air motors and all electronics).**

# LED PUCK BATTERY CHANGE INSTRUCTION

## (Includes the Lithium Battery)

### STEP ONE:

Remove screws and back cap from LED Puck using **Small** Phillips Screwdriver (not provided).

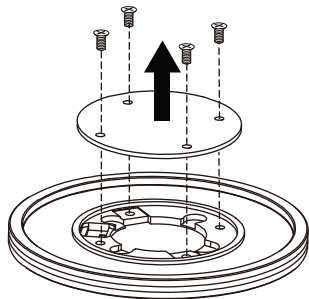

### STEP TWO:

Remove CR2016 Lithium Battery 3V from LED Puck.

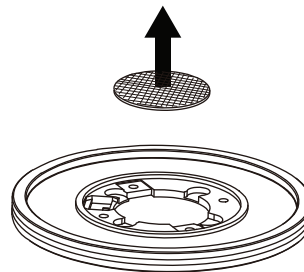

IF BATTERY HOLDER BRACKET MOVES, RE-INSTALL IT TO LED PUCK AS SHOWN IN DIAGRAM.

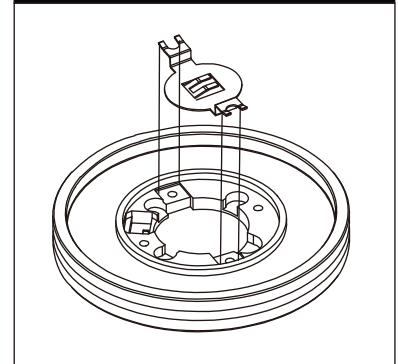

### STEP THREE:

Insert new CR2016 Lithium Battery 3V into LED Puck.

Positive "+"  
on bottom  
side

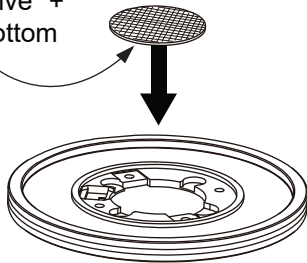

### STEP FOUR:

Install back cap and secure screws with Phillips Screwdriver (not provided).

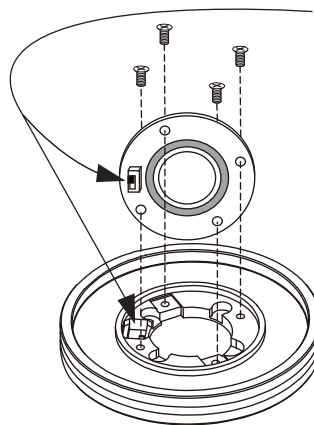

#### NOTE:

Make sure the on/off switch on the back cap properly aligns and fits into its slot in the LED puck during reassembly

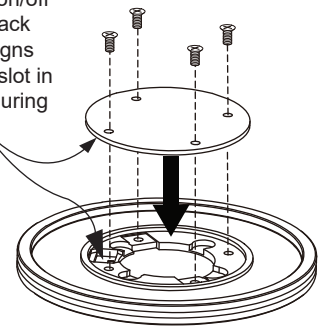

### Helpful Hint:

The LED puck battery will last approximately 7 hours of continuous play. The puck battery is not rechargeable. Be sure to turn the switch to the "OFF" position when **not in use to conserve your battery life.**

# LED STRIKER BATTERY INSTALLATION/REPLACE INSTRUCTION

## (Does not Include the 4 pcs AAA Batteries)

Carefully twist  
top cap off to  
replace batteries

Top cap

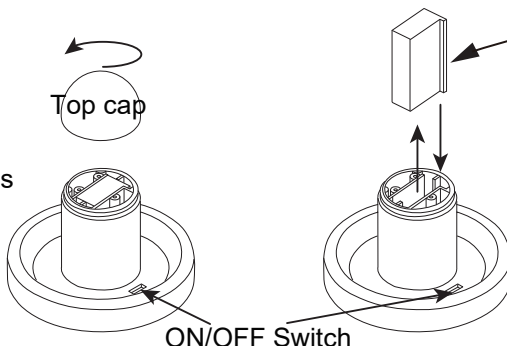

Carefully replace  
top cap when the  
batteries are replaced.

Do not cross thread

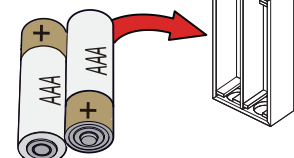

(Batteries not included).

**Make sure polarity is correct.**

### Helpful Hint:

Be sure to turn the switch to the "OFF" position when not in use.

See "FIRST TIME BATTERY INSTALLATION AND NOTICE", before installing batteries, located on **page 13.**

## First Time Battery Installation:

Locate battery compartment for this product .  
Use alkaline batteries for maximum performance .

Remove battery compartment cover .

**Install new batteries only after reading the “ Battery Information NOTICE” !**

Replace compartment cover and secure cover.

### **IMPORTANT: BATTERY INFORMATION**

**Please retain this information for future reference. Batteries must be installed / replaced by an adult .**

## Notice:

1. Remove and replace batteries when the electrical features of this product work slowly or are not functional .
2. Do not mix old and new batteries .
3. Do not mix different types of batteries : Alkaline , Standard ( Carbon-Zinc ) , or rechargeable ( Nickel-Cadmium batteries ) .
4. Use Alkaline Batteries for maximum performance .
5. Do not use damaged batteries .
6. Use only batteries of the same or equivalent type as recommended.
7. Install new batteries as per matching the battery polarity guide ( + & - , positive and negative ) inside of the battery compartment . Correct battery polarity installation is critical as to not damage the internal electrical components as well as insuring the correct functionality of the product .
8. Do not short circuit the battery terminals .
9. Always remove exhausted , leaking , weak , and batteries from long periods of nonuse from the product . Battery leakage and corrosion can cause damage .
10. Check the battery terminals are clean and bright before installing new batteries.
11. Dispose of old batteries safely and per local battery disposal codes .
12. Do not dispose of batteries into a fire as they may explode or leak.
13. If removable rechargeable batteries are used , they are to be charged under adult supervision .
14. Rechargeable batteries are to removed from the product before they are charged .
15. If you use a battery charger, it should be examined regularly for damage to the cord , plug, enclosure, and other parts. Do not use a damaged or malfunctioning charger until it is properly repaired.
16. Non rechargeable batteries must not be recharged .
17. Always remove batteries from this product for extended storage and or non-use .
18. Should this product cause , or be affected by, local electrical interference , move it away from other electrical equipment . Reset ( switching off and back on again and or removing and reinserting the batteries ) if necessary .

Congratulations! You have now assembled your game table. Please note the Care and Use instructions below to insure many years of trouble free use of your game table.

## CARE AND USE OF YOUR TABLE

1. Use spray furniture polish to clean all exterior surfaces of your table.
2. Use spray furniture polish on the AH playing surface with motor running. This will protect the playing surface + make the pucks go faster.
3. This product is intended for **INDOOR** use only.
4. **DO NOT** sit, climb or lean on the table.
5. **DO NOT** drag the table when moving it. This will damage the legs.
6. **DO NOT** set drinks on the table.
7. The purchase of a table cover will both protect and help keep clean the entire top of the table.
8. Use a carpenter's level to properly level the table using the enclosed A6 leveling shims.

## PRODUCT PARTS LIST FOR MODEL # AL1200W/F

Key #	Part #	Description	Qty.
H1	AL1200SYH1	8mm x 40mm Hex Head Bolt	12
H2	AL1200SYH2	M8 Flat Washer	16
H3	AL1200SYH3	M8 Lock Washer	16
H4	AL1200SYH4	3.5mm x 35mm Phillips Flat Head Screw	14
H5	AL1200SYH5	3.5mm x 35mm Phillips Flat Head Screw	14
T1	AL1200SYT1	8mm x 130mm Hex Head Bolt	4
P1	AL1200SYP1	Main Cabinet with Air Motor & Puck Catchers	1
P2	AL1200SYP2	Universal Leg	4
P3	AL1200SYP3	Decorative Leg Wooden Block	2
P4	AL1200SYP4	Wooden End Block	2
P5	AL1200SYP5	Top Panel of Lower Center Support Beam	1
P6	AL1200SYP6	Side Panel of Lower Center Support Beam	2
A1	AL1200SYA1	LED Striker	2
A2	AL1200SYA2	LED Puck	1
A3	AL1200SYA3	Puck	1
A4	AL1200SYA4	Felt Pad	2
A5	AL1200SYA5	A/C Adapter	1
A6	AL1200SYA6	Table Leveling Shim	4
A7	AL1200SYA7	Metal Corner Cap(pre-installed)	4
C1	AL1200SYC1	LED Rail With Long Wire	1
C2	AL1200SYC2	LED Rail With Short Wire	1
C3	AL1200SYC3	Control Box	1
C4	AL1200SYC4	Sensor With Long Wire	1
C5	AL1200SYC5	Sensor With Short Wire	1
C6	AL1200SYC6	Air Motor	1
C7	AL1200SYC7	Scorer	1
C8	AL1200SYC8	Battery Box	1
C9	AL1200SYC9	LED Rail Cover	2
K1	AL1200SYK1	Hardware Kit	1
M1	AL1200SYM1	Owner's Manual	1

# INSTRUCTIONS FOR LEVELING A GAME TABLE

- Assemble game table according to the instruction.
- Any type of level would be sufficient to perform this procedure. However, a two-foot level is recommended.
- Before leveling, make sure level is placed on the playing surface if possible, not the rails.
- Level the ends: Place the level on the playing surface and adjust the height by placing shims (A6) underneath the leg opposite of which the bubble in the level favors until the bubble rests in the middle of the level.

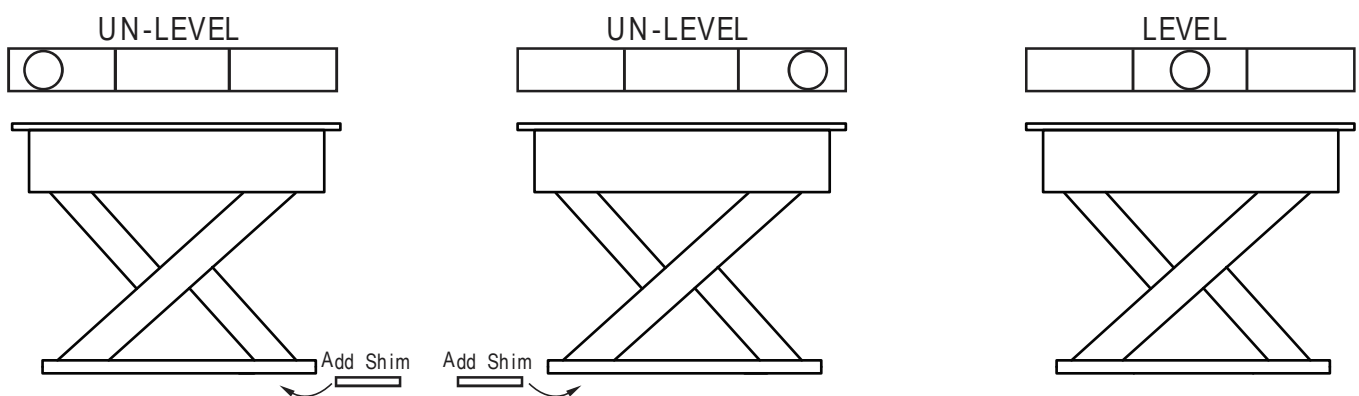

- Repeat the step above to the opposite end of the game table.
- Next, level the length of the table. Place the level next to the side of the table and adjust the height to position the bubble in the middle of the level, using the shims opposite of which the bubble in the level favors.
- Repeat the step above to the opposite length of the table.
- Recheck both short ends to ensure bubble is in the middle on the level.
- Depending on the surface the game table sits, especially deep pile carpeting, the game table needs to settle for 24 hours. Recheck the level on each side of the table after 24 hours.



## 90 DAY LIMITED WARRANTY

This consumer warranty extends to the original consumer purchase of any ESCALADE SPORTS Product (hereinafter referred as the "Product").

**WARRANTY DURATION:** This Product is warranted to the original consumer purchase of a period of 90 days from the original purchase.

**WARRANTY COVERAGE:** ESCALADE SPORTS warrants to the original Consumer Purchaser that any Product of its manufacture is free from defects in material and workmanship when used for the intended purpose under normal use and conditions. THIS WARRANTY IS VOID IF THE PRODUCT HAS BEEN DAMAGED BY ACCIDENT, UNREASONABLE USE, NEGLIGENCE, IMPROPER SERVICE, FAILURE TO FOLLOW INSTRUCTIONS PROVIDED WITH THE PRODUCT OR OTHER CAUSES NOT ARISING OUT OF DEFECTS IN MATERIAL AND WORKMANSHIP.

**WARRANTY PERFORMANCE:** During the above 90 day warranty period, ESCALADE SPORTS shall repair or replace with a comparable model, and Product, or component thereof, which may prove defective under normal use and proper care, and which our examination shall disclose to our satisfaction to be thus defective, please contact our Warranty Dept.

1-888-996-2729 / Warranty Dept.

Or Write us at:

Escalade® Sports, Inc. - P.O. Box 889, Evansville, IN 47706

Attn: Warranty Dept.

Or E-mail us at:

gameroom@escaladesports.com

Other than shipping requirements no charge will be made for such repair or replacement of in-warranty Products. ESCALADE SPORTS strongly recommends that the Product is insured for value prior to mailing.

**WARRANTY DISCLAIMERS:** ANY IMPLIED WARRANTIES ARISING OUT OF THIS SALE, INCLUDING BUT NOT LIMITED TO THE IMPLIED WARRANTIES OF MERCHANTABILITY AND FITNESS FOR A PARTICULAR PURPOSE, ARE LIMITED IN DURATION TO THE ABOVE 90 DAY PERIOD. ESCALADE SPORTS SHALL NOT BE LIABLE FOR LOSS OF USE OF THE PRODUCT OR OTHER CONSEQUENTIAL OR INCIDENTAL COSTS, EXPENSES OR DAMAGES INCURRED BY THE CONSUMER OF ANY OTHER USE.

Some states do not allow the exclusion or limitation of implied warranties or consequential or incidental damages, so the above limitations or exclusions may not apply to you.

**LEGAL REMEDIES:** This warranty gives you specific legal rights and you may also have other rights which may vary from state to state.

### NOT COVERED BY THIS WARRANTY

- Product not intended to be in places of public assembly, such as, but not limited to, schools, parks, public or private recreational facilities
- Any product subjected to Non-residential abuse, negligence, improper installation, vandalism, acts of God, alteration of product, or any other events beyond the control of ESCALADE SPORTS.