

# mongoose®

## FOLDING SCOOTER OWNER'S MANUAL



### WARNING

This manual contains important safety and use information. Keep this manual for future reference.

- An adult must read this entire manual
- Adult supervision is required at all times

Styles may vary

## Congratulations on your new scooter!

Proper assembly and operation of your scooter is important for your safety and enjoyment. Our customer service department is dedicated to your satisfaction with Pacific Cycle and its products. If you have questions or need advice regarding assembly, parts, performance, or returns, please contact the experts at Pacific Cycle. Enjoy the ride!

Toll free: 1-800-626-2811

Customer Service hours: Monday - Friday 8 AM- 5 PM Central Standard Time (CST)

You may also reach us at:

**Web:** [www.pacific-cycle.com](http://www.pacific-cycle.com)

**Email:** [customerservice@pacific-cycle.com](mailto:customerservice@pacific-cycle.com)

**Mail:** P. O. Box 344  
4730 E. Radio Tower Lane  
Olney, IL 62450

**Do not return this item to the store. Please call Pacific Cycle customer service if you need assistance.** You will need your model number and date code located on the service sticker.

## About This Manual

It is important for you to understand your new scooter. By reading this manual before you go out on your first ride, you'll know how to get better performance, comfort, and enjoyment from your new scooter. It is also important that your first ride on your new scooter is taken in a controlled environment, away from cars, obstacles and cyclists.

This manual contains important information regarding safety, assembly, use, and maintenance of the scooter but is not intended to be a complete or comprehensive manual covering all aspects concerning scooter ownership. We recommend consulting an expert if you have any doubts or concerns regarding your experience or ability to properly assemble and maintain the scooter.

## A Special Note For Parents and Guardians

It is a tragic fact that most scooter accidents involve children. As a parent or guardian, you bear the responsibility for the activities and safety of your minor child. Among these responsibilities are to make sure that the scooter which your child is riding is properly fitted to the child; that it is in safe operating condition; that you and your child have learned, understand and obey not only the applicable local motor vehicle, scooter, and traffic laws, but also the common sense rules of safe and responsible scooting. As a parent, you should read this manual before letting your child ride the scooter. Please make sure that your child always wears an approved helmet when riding.

# ① Safety

## Safety Warning Messages

The following Safety Warning Messages indicates a potential personal injury hazard. Failure to follow the warnings may result in damage to property, injury, or death.

This manual contains many Warnings and Cautions concerning the consequences of failure to follow safety warnings. Because any fall can result in serious injury or even death, we do not repeat the warning of possible injury or death whenever the risk of falling is mentioned.

### **WARNING**

Indicates a hazard or unsafe practice that will result in severe injury or death. Failure to read, understand and follow the safety information in this manual may result in serious injury or death.

### **CAUTION**

Indicates a hazard or unsafe practice that could result in minor injury.

### **NOTICE**

Indicates a hazard unrelated to personal injury, such as property damage.

## Age and Weight Range

| Product Name                       | Age | Max Weight |
|------------------------------------|-----|------------|
| Mongoose Force 1.0 Folding Scooter | 5+  | 176 lb     |
| Mongoose Force 2.0 Folding Scooter | 5+  | 176 lb     |
| Mongoose Force 3.0 Folding Scooter | 8+  | 220 lb     |
| Mongoose Force 4.0 Folding Scooter | 8+  | 220 lb     |

# WARNING

- Read and understand all product & safety warnings
- Always wear safety equipment such as helmet, knee pads and elbow pads. Always wear a helmet when riding your scooter and keep the chinstrap securely buckled. Always wear shoes.
- Ride on smooth, paved surfaces away from motor vehicles.
- Avoid sharp bumps, drainage grates, and sudden surface changes. Scooter may suddenly stop.
- Avoid streets and surfaces with water, sand, gravel, dirt, leaves, and other debris. Wet weather impairs traction, braking, and visibility.
- Do not ride at night.
- Brake will get hot from continuous use. Do not touch after braking.
- Avoid excessive speed associated with downhill rides.
- Adults must assist children in the initial adjustment procedures to unfold scooter, adjust handlebar and steering to height, and finally to fold scooter.
- Obey all local traffic and scooter riding laws and regulations.
- Watch out for pedestrians.
- Check and secure all fasteners before every ride.
- Replace worn or broken parts immediately.
- Never allow more than one rider
- Keep fingers and other body parts away from all moving components
- Units are not designed for racing, stunt riding or other maneuvers which may cause loss of control, or may cause uncontrolled operator actions or reactions
- Using your scooter safely depends upon your diligence in following the warnings, cautions, and instructions in this owner's manual. Using your scooter safely also depends upon your own good judgment and/or common sense, as well as that of your provider, caregiver, and/or healthcare professional. Pacific Cycle is not responsible for injuries and/or damage resulting from any person's failure to follow the warnings, cautions, and instructions in this owner's manual
- Persons with the following conditions shall be cautioned not to operate: Those with heart conditions, pregnant women, persons with head, back, or neck ailments, or prior surgeries to those areas of the body. Persons with any mental or physical conditions that may make them susceptible to injury or impair their physical dexterity or mental capabilities to recognize, understand, and perform all of the safety instructions and to be able to assume the hazards inherent in the use of the scooter.
- Never hitch on to another vehicle and never pull anyone or anything
- Failure to heed the warnings listed above increases risk of serious injury

## Riding Safely

### **WARNING**

Riding the scooter in unsafe conditions (i.e.: at night), in an unsafe manner, or disregarding traffic laws may result in an unexpected movement, loss of control, and serious injury or death.

### General Safety

- Familiarize yourself with all the scooter's features before riding. Practice braking.
- Expect the unexpected (e.g., opening car doors or cars backing out of concealed driveways).
- Maintain a comfortable stopping distance from all other riders, vehicles and objects. Safe braking distances and forces are subject to the prevailing weather conditions.
- Use original spare parts only. Do not make structural changes or modifications to the scooter.
- Wear proper riding attire, reflective if possible, and avoid open toe shoes.
- Do not use items that may restrict your hearing and vision.
- Do not allow passengers and do not carry packages that will interfere with your visibility or control of the scooter.
- Do not ride indoors or on surfaces that could be damaged such as carpet or flooring

### Road Conditions

- Be aware of road conditions. Concentrate on the path ahead. Avoid pot holes, gravel, wet road markings, oil, curbs, speed bumps, drain grates and other obstacles.
- Cross train tracks at a 90 degree angle or walk your scooter across.
- Avoid sharp bumps, drainage grates & sudden surface changes
- Wet weather impairs traction, braking & visibility

### Cornering Technique

- Brake slightly before cornering and prepare to lean your body into the corner.
- Decrease your riding speed, avoid sudden braking and sharp turns.

### Safe Riding Rules for Children

- Be aware of other vehicles behind and nearby.
- If riding downhill, be extra careful. Slow down using the brakes and maintain control of the steering.
- Keep both hands on handlebars at all times.
- Not designed for stunt riding
- Always use caution when riding and wear protective gear

## Personal Safety

### **WARNING**

Riding a scooter without protective gear, clothing, shoes, or a helmet may result in serious injury or death. Always wear protective gear, clothing, and helmet when riding the scooter. Ensure protective gear does not interfere with steering, or braking.

#### **Protective Gear and Clothing**

##### **Always wear: Figure 1.1**

- Colors that are easily seen and, if possible, reflective clothing.
- Clothing appropriate for the weather conditions.
- Always wear shoes
- Use of protective gear such as pads for the knees and elbows is highly recommended for children.
- A properly fitted, ASTM or SNELL approved, helmet shall be worn at all times by riders of the scooter. For information regarding how to properly fit a helmet visit:  
<http://www.nhtsa.gov/people/injury/pedbimot/bike/easystepsweb>

##### **Do not wear:**

- Loose clothing parts, strings, or jewelry that may become entangled with moving parts on the scooter or interfere with handling of the scooter.
- Shoes with untied shoe laces.

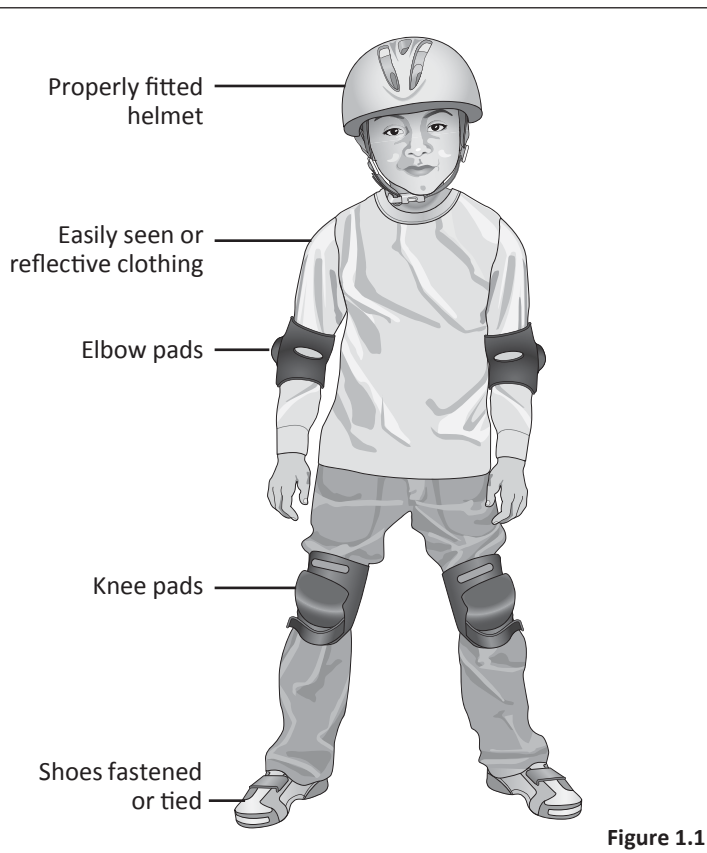

**Figure 1.1**

## Helmet Use

**Important!** Many states have passed helmet laws regarding children. Make sure you know your states helmet laws. It is your job to enforce these rules with your children. Even if your state does not have a children's helmet law, it is recommended that everyone wear a helmet.

It is strongly advised that a properly fitting, ASTM or SNELL approved, helmet be worn at all times when riding your scooter.

### The correct helmet should: Figure 1.2

- Be comfortable
- Have good ventilation
- Fit correctly
- Cover forehead

### Incorrect helmet position: Figure 1.3

- Helmet **does not** cover the forehead



Figure 1.2

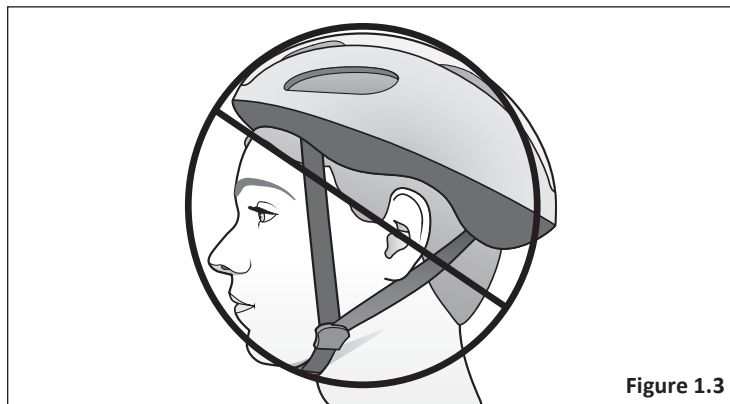

Figure 1.3

## 2 Unfolding the Scooter



### Note

The scooter comes completely assembled. Follow the steps below to unfold the scooter.

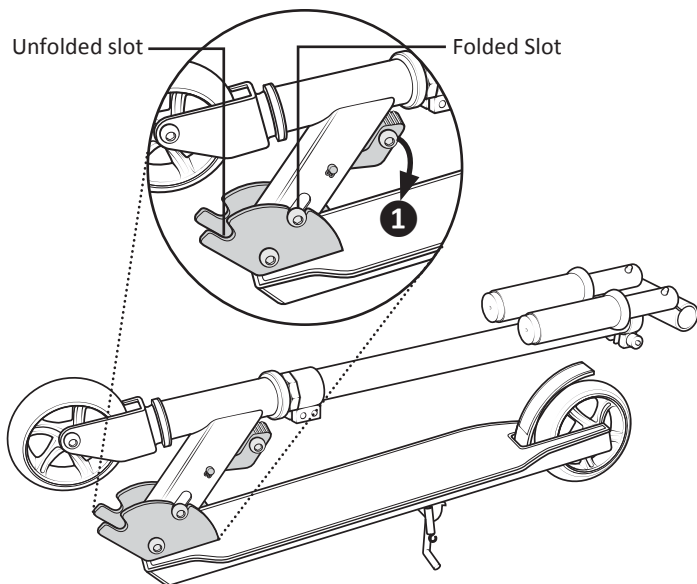

- 1** The bolt on the folding mechanism will be in the folded slot. Push down the release lever.

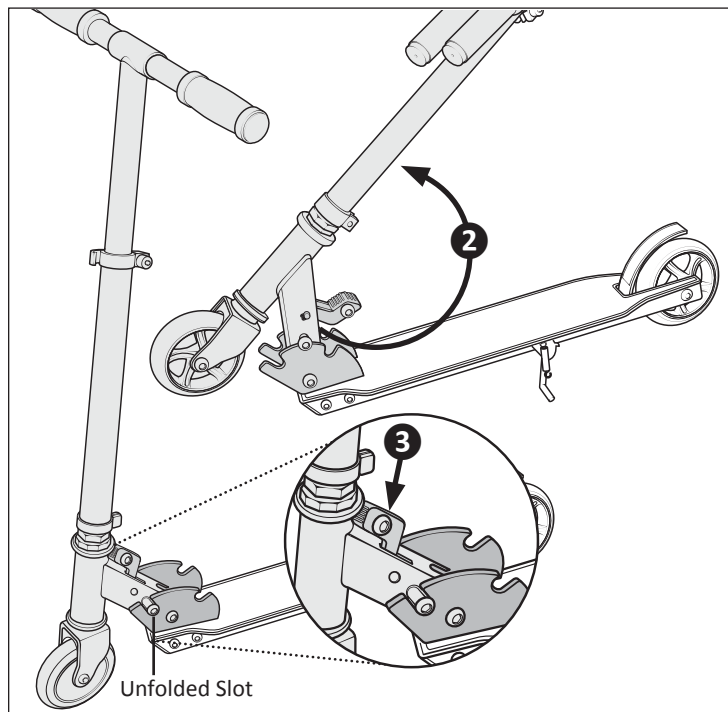

- 2** Rotate the front tube up until bolt on the folding mechanism is in the unfolded slot.
- 3** Push release lever forward to lock into place.



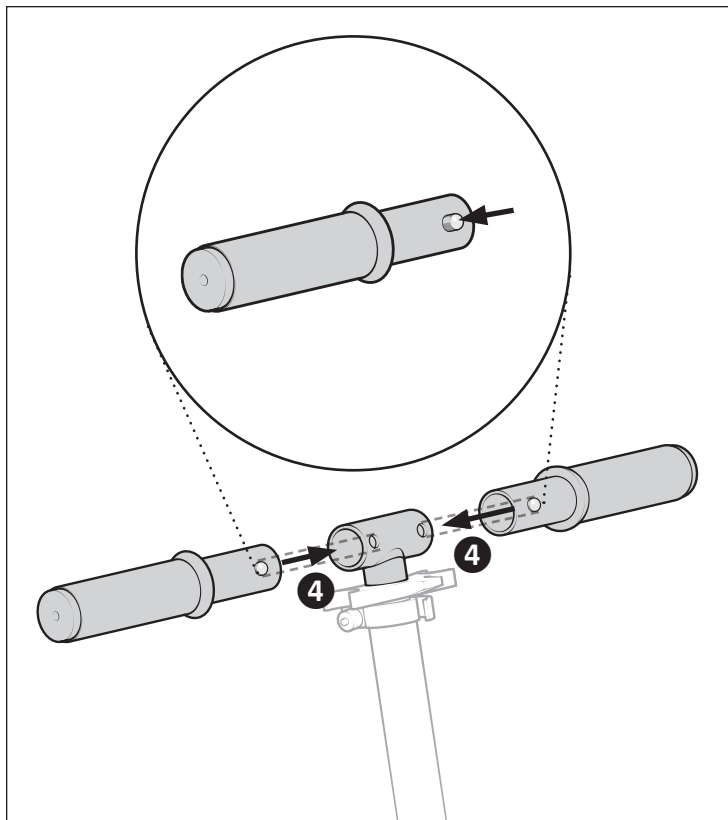

- 4** Insert and secure the left and right handlebars by pressing the push buttons inserting them into the corresponding holes in the T-bar.

## Adjusting Handlebar Height

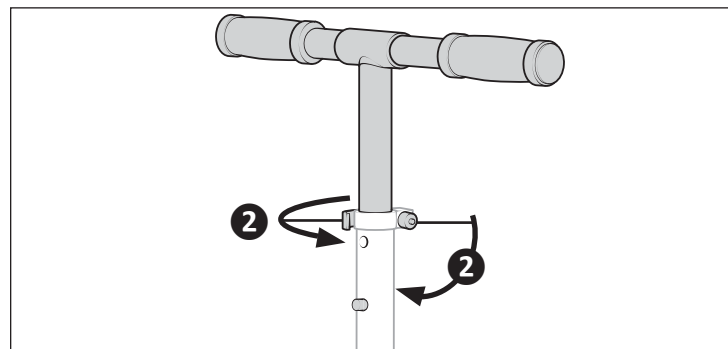
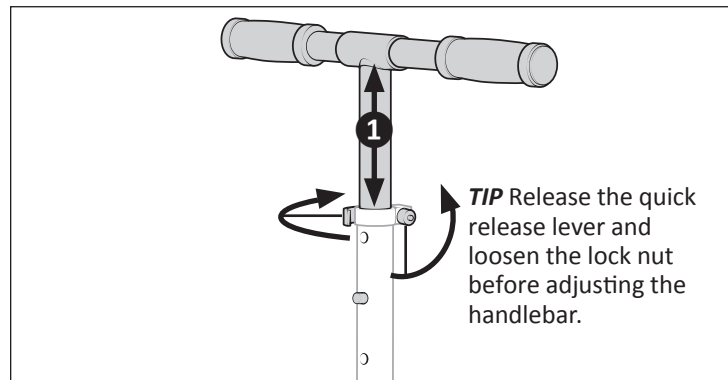

- 1** The scooter has multiple holes for the push button to lock into. Lock the handlebars at the desired height.
- 2** Tighten the lock nut and quick release lever.

## ③ Use

- ① Grip handlebars firmly with both hands.
- ② With one foot firmly on the scooter, begin to slowly push the scooter forward with the other foot.
- ③ Brake by pressing down on the rear wheel stop until contact is made with the wheel.
- ④ If the scooter model comes with a kickstand use it to hold scooter in upright position.

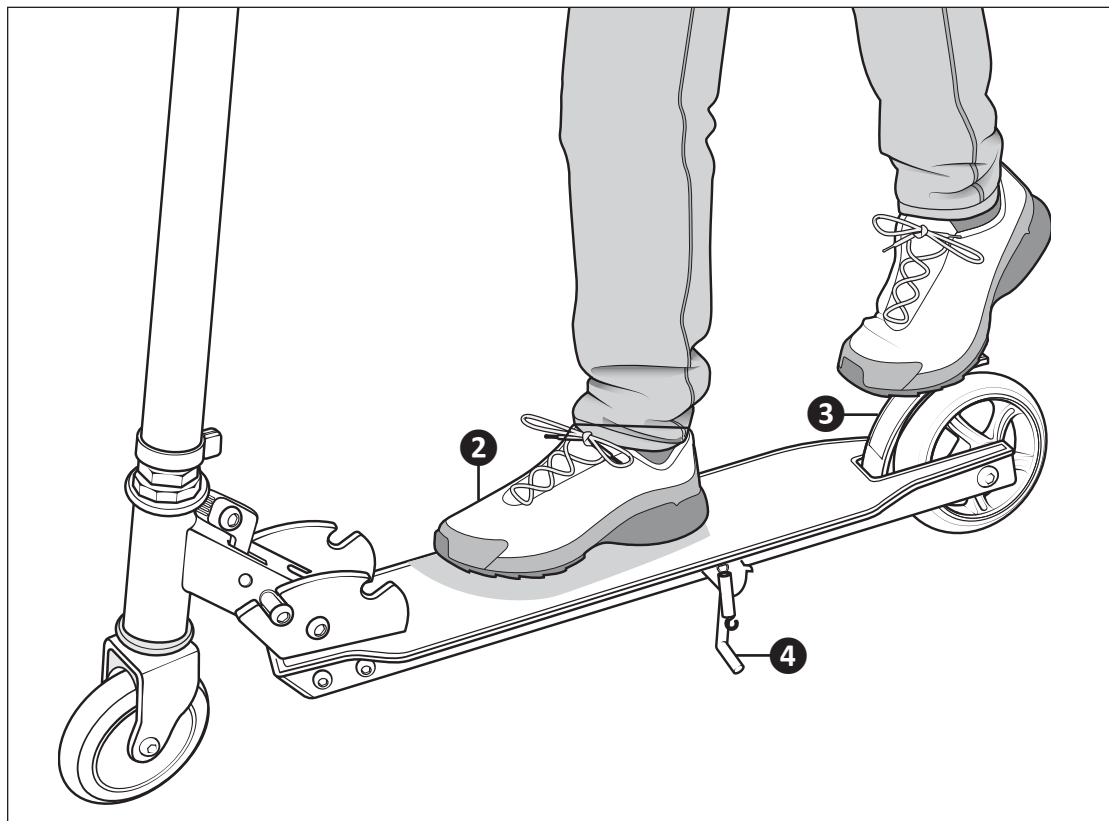

## ④ Maintenance

### WARNING

Proper maintenance is critical to the performance and safe operation of the scooter. Always inspect the scooter and conduct necessary maintenance before each use of the scooter. Failure to conduct maintenance on the scooter may result in malfunction of a critical part or serious injury or death.

This section presents important information on maintenance and will assist you in determining the proper course of action to take if you do have a problem with the operation of the scooter. If you have questions regarding maintenance please call our customer service, toll free, at **1-800-626-2811** or see a qualified bicycle mechanic. **Do not** call the store where the scooter was purchased.

#### **Correct routine maintenance of your new scooter will ensure:**

- Smooth running
- Longer lasting components
- Safer riding
- Lower running costs

### **Basic Maintenance**

The following procedures will help you maintain your scooter for years of enjoyable riding.

- For painted frames, dust the surface and remove any loose dirt with a dry cloth. To clean, wipe with a damp cloth soaked in a mild detergent mixture.
- Clear any debris between the wheels and frame
- Store your scooter under shelter. Avoid leaving it in the rain or exposed to corrosive materials.
- Riding on the beach or in coastal areas exposes your scooter to salt which is very corrosive. Wash your scooter frequently.
- If paint has become scratched or chipped to the metal, use touch up paint to prevent rust. Clear nail polish can also be used as a preventative measure.
- Check that the wheels are securely fastened to the scooter and axle nuts are tight.

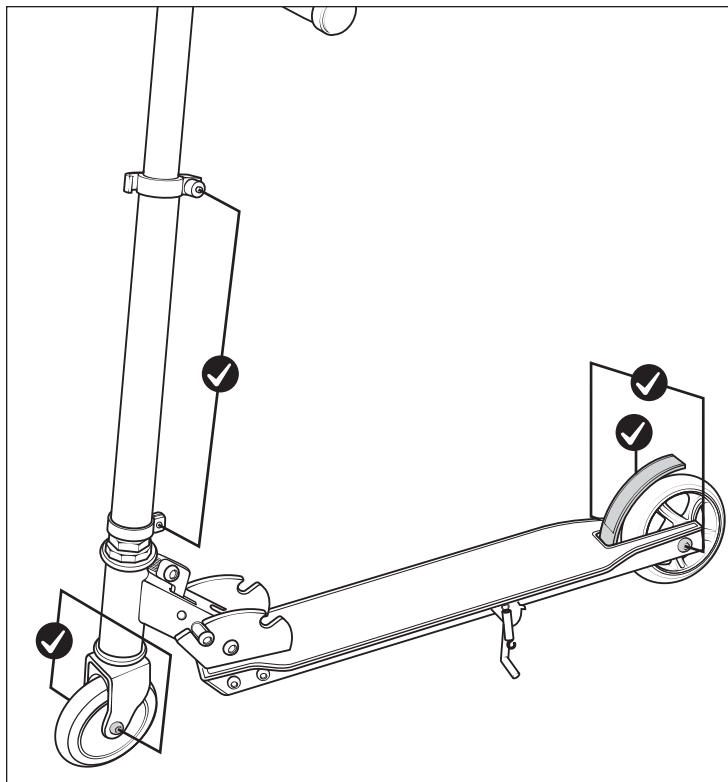

Before you ride check:

- That all of the locking nuts are firmly tightened
- That the brake can make contact with the wheel.

## 5 Service

Do not return this product to the place of purchase. If your scooter needs service, repairs or replacement parts, please have the model and serial number available and call:

### UNITED STATES

#### Pacific Cycle Consumer Relations

**Hours:** 8:00 am – 5:00 pm (CST) Monday - Friday

**Phone:** 1-800-626-2811

**Email:** customerservice@pacific-cycle.com

### CANADA

#### Pacific Cycle Canada

**Hours:** 8:00 am – 5:00 pm (CST) Monday - Friday

**Phone:** 1-877-758-4741

**Email:** customerservice@pacific-cycle.com

### MEXICO

#### Bicicletas Mercurio

**Phone:** 01-800-2288-2424

**Email:** soporte tecnico@bicmercurio.com.mx

### AUSTRALIA

#### Monza Imports

**Phone:** 61 3 8327 8080

**Email:** cyclcing@monzaimports.com.au

## **⑥ Warranty**

### **LIMITED WARRANTY AND POLICY ON REPLACEMENT PROCEDURES & RESPONSIBILITIES**

Your purchase includes the following warranty which is in lieu of all other express warranties. This warranty is extended only to the initial consumer purchaser. No warranty registration is required. This warranty gives you specific legal rights and you may have other rights which vary from state to state.

#### **FRAME**

Frames are guaranteed against manufacturing defects for a period of 5 years. If frame failure should occur due to faulty materials or workmanship during the guarantee period, the frame will be replaced. For frame replacement under this Pacific Limited Warranty, contact us, stating the nature of the failure, model number, date received and the name of the store from which the scooter was received, at the address given on this page. Frame must be returned for inspection at customer's expense. The length of the useful life cycle will vary depending on the type of scooter, riding conditions and care the scooter receives. Competition, jumping, downhill racing, trick riding, trial riding, riding in severe conditions or climates, riding with heavy loads or any other non-standard use can substantially shorten the useful product life cycle. Any one or a combination of these conditions may result in an unpredictable failure that is not covered by this warranty.

#### **PARTS**

All other parts of the unit except Normal Wear Parts are warranted against defective materials and workmanship for a period of 1 year from the date of purchase by the initial consumer purchaser, subject to the Terms and Conditions of the warranty listed below. If failure of any part should occur due to faulty materials or workmanship during the warranty period, the part will be replaced. All warranty claims must be submitted to the address below and must be shipped prepaid and accompanied by proof of purchase. Any other warranty claims not included in this statement are void. This especially includes installation, assembly, and disassembly costs. This warranty does not cover paint damage, rust, or any modifications made to the scooter. Normal Wear Parts are defined as grips, wheels, and brake mechanism. These parts are warranted to be free from defects in material and workmanship as delivered with the product. Any claim for repair or replacement of Normal Wear Parts (grips, wheels, brake mechanism) and missing parts must be made within thirty (30) days of the date of purchase. The warranty does not cover normal wear and tear, improper assembly or maintenance, or installation of parts or accessories not originally intended or compatible with the scooter as sold. The warranty does not apply to damage or failure due to accident, abuse, misuse, neglect, or theft. Claims involving these issues will not be honored.

#### **CONDITIONS OF WARRANTY**

1. Your scooter has been designed for general transportation and recreational use, but has not been designed to withstand abuse associated with stunting and jumping. This warranty ceases when you rent, sell, or give away the scooter, ride with more than one person, or use the scooter for stunting or jumping.
2. This warranty does not cover ordinary wear and tear or anything you break accidentally or deliberately.
3. It is the responsibility of the individual consumer purchaser to assure that all parts included in the factory-sealed carton are properly installed, all functional parts are initially adjusted properly, and subsequent normal adjustments necessary to keep the scooter in good operating condition are properly made. This warranty does not apply to damage due to improper installation of parts, installation of any kind of power plant or internal combustion engine, modification or alteration of the brakes, or frame in any way, or failure to properly maintain or adjust the scooter. NOTICE: Scooter specifications subject to change without notice.

A DIVISION OF DOREL INDUSTRIES™  
**PACIFICCYCLE**

© 2019 Pacific Cycle Inc.  
4902 Hammersley Rd.  
Madison, WI 53711

Made in China