



COMPACT FIRE RING



**WARNING & INSTRUCTION BOOKLET
MODEL GCLOG-2**

⚠ WARNING

FOR OUTDOOR USE ONLY

Installation and service must be preformed by a qualified installer, service agency, or the gas supplier.

⚠ DANGER

FIRE OR EXPLOSION HAZARD

If you smell gas:

- Shut off gas to the appliance.
- Extinguish any open flame.
- If odor continues, leave the area immediately.
- After leaving the area, call your gas supplier or fire department.

Failure to follow these instructions could result in fire or explosion, which could cause property damage, personal injury, or death.

⚠ WARNING

Do not store or use gasoline or other flammable vapors and liquids, in the vicinity of this or any other appliance. An LP cylinder not connected for use shall not be stored in the vicinity of this or any other appliance.

⚠ DANGER

CARBON MONOXIDE HAZARD



This appliance can produce carbon monoxide which has no odor. Using it in an enclosed space can kill you. Never use this appliance in an enclosed space such as a camper, tent, car or home.

⚠ WARNING

Read and follow all warnings and instructions before assembling and using this appliance.

If the information in this manual is not followed exactly, a fire or explosion may result causing property damage, personal injury or loss of life.

⚠ WARNING

Improper installation, adjustment, alteration, service or maintenance can cause injury or property damage. Read the installation, operating and maintenance instructions thoroughly before installing or servicing this equipment.

⚠ WARNING

- **INSTALLER:** Leave this manual with the appliance.
- **CONSUMER:** Retain this manual for future reference.

DO NOT DISCARD THIS INSTRUCTION MANUAL

Max Inlet Pressure 11" H2O, 27 mbar

PARTS LIST

MODEL - GCLOG -2

ITEMS NOT SHOWN
QTY 1 - CARRY BAG (GCLOG-BAG)
12 POUNDS LAVA ROCK

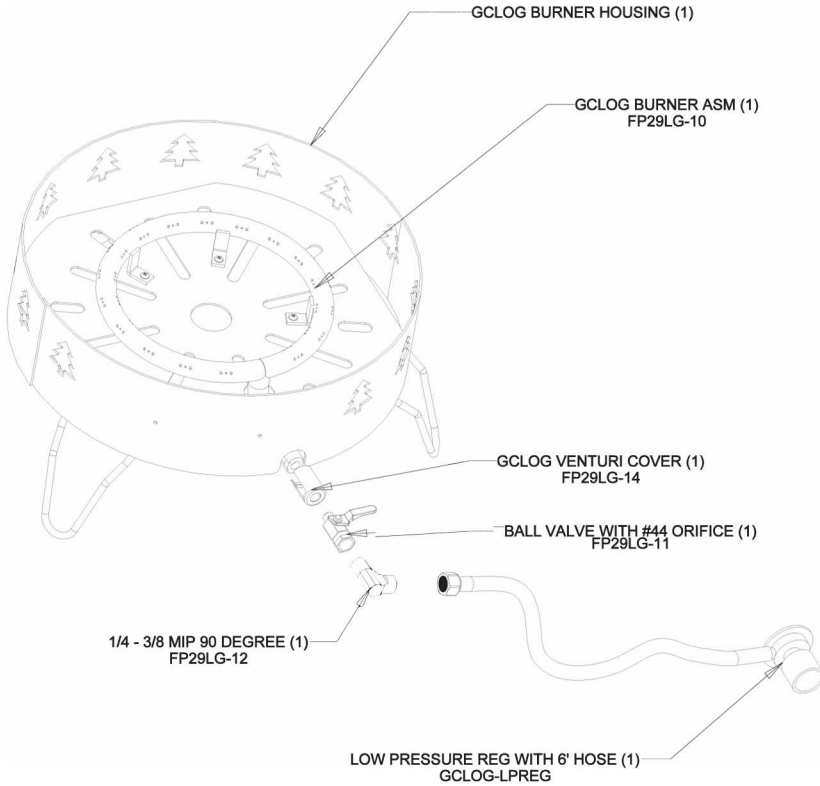



ASSEMBLY INSTRUCTIONS

1. Arrange the 12 pounds of lava rock around the burner. For a more realistic looking flame arrange the rock to cover most of the tube burner.

⚠ WARNING

DO NOT use this fire pit in a manner other than its intended purpose. Not intended for commercial use. Not intended to be installed or used in or on a recreational vehicle or boat. Keep a fire extinguisher accessible at all times. The use of alcohol, prescription or nonprescription drugs may impair the consumer's ability to properly assemble or safely operate this fire pit. Solid fuels shall not be burned in this gas fireplace.

FOR OUTDOOR USE ONLY!

Do not operate the fire pit indoors, in a garage, or in any other enclosed area or under overhead construction. Do not operate fire pit near flammable materials such as decks, fences, porches or carports. A minimum clearance range of 72" inches is recommended. Do not use the fire pit near gasoline or other combustible liquids or where combustible vapors may be present.

Children and adults should be alerted to the hazards of high surface temperatures and should stay away to avoid burns or clothing ignition. Young children should be carefully supervised when they are in the area of the appliance. Clothing or other flammable materials should not be hung from the appliance, or placed on or near the appliance. Any guard or other protective device removed for servicing the appliance must be replaced prior to operating the appliance.

Installation and repair should be done by a qualified service person. The appliance should be inspected before use and at least annually by a qualified service person. More frequent cleaning may be required as necessary. It is imperative that control compartment, burners and circulating air passageways of the appliance be kept clean.

Use caution when assembling and operating fire pit to avoid cuts and scrapes from rough or sharp edges.

DO NOT move the fire pit while it is in use. Allow the fire pit to cool completely before moving or storing.

When in use, the fire pit must be on a level, stable surface in an area clear of combustible material. An asphalt surface (blacktop) may not be acceptable for this purpose. Do not operate fire pit on flammable material such as carpet or a wood deck. Store the fire pit in a dry, protected location.

This fire pit is not intended for and should never be used as a heater.

DO NOT leave fire pit unattended while in use. Operate the fire pit with close supervision.

DO NOT operate around children or animals.

DO NOT bump or tip fire pit. If fire pit becomes extremely hot, allow fire pit to cool completely before handling. If you must handle the fire pit while it is hot, always wear protective oven mitts or heat resistant gloves when handling the fire pit or its components.

DO NOT obstruct flow of combustion air and/or ventilation air for fire pit.

DO NOT wear loose clothing while operating the fire pit. Tie back long hair while operating the fire pit. ALWAYS wear fully covering shoes while operating the fire pit.

Allow fire pit and its components to cool completely before conducting any routine cleaning or maintenance. Do not move the fire pit when in use. Allow the fire pit to cool before moving or storing.

DO NOT use this appliance if any part has been under water. Immediately call a qualified service technician to inspect the appliance and to replace any part of the control system and any gas control which has been under water.

An LP cylinder not connected for use should not be stored in the vicinity of fire pit or any other fire pit. Do not store spare LP cylinders within 10 feet of fire pit. LP cylinders must be stored outdoors, out of reach of children. Do not store a spare LP-gas cylinder under or near this fire pit. Never fill the cylinder beyond 80 percent full. Failure to follow these instructions exactly could result in a fire causing death or serious injury.

While the fire pit is not in use, the gas must be turned off at the supply cylinder. The fire pit should be shut off and all supply valves (on piping or on fuel cylinders) should be closed in the event that the odor of unburned gas is detected. Do not attempt to use the unit until any gas leaks are fixed. Do not use the fire pit if the burner fails to light or fails to remain lit. Under such conditions, gas should be shut off and fuel cylinders should be disconnected. Do not operate under high wind conditions. All installations are to conform to local codes. In the absence of local codes, installation should conform to the National Fuel Gas Code, ANSI Z223.1/NFPA 54

Fire pit should be installed with the hose regulator assembly extended at full length of hose directly away from the burner. When so configured, placement results in maximum tank to fire pit distance. When fire pit is operated, the hose/regulator and gas tank should be on a line perpendicular to wind direction.

Placing tank closer than 48" to the fire pit can overheat the tank and cause release of propane through relief openings and can result in tank fire or explosion. Make sure the hose does not touch any part of the burner drum housing. Care should be taken to protect the fuel supply hose from damage from either foot or vehicle traffic.

CONNECTING THE LP TANK

1. The knob on the LP tank must be closed. See that the knob is turned clockwise to a full stop.
2. Check that the control knob on the fire pit is turned off.
3. Remove the protective cap from the LP tank valve and coupling nut, if present.
4. Hold the regulator in one hand and insert the nipple into the valve outlet. Be sure the nipple is centered in the valve outlet. The coupler connects to the large outside threads on the valve outlet
5. Hand tighten the coupler clockwise until it comes to a full stop. Firmly tighten by hand only.



(B) Nipple has to be centered into the LP tank valve



(C) Hold coupling nut and regulator as shown for proper connection to LP tank valve

The fire pit is to be used only with the 20 pound, vertical standing vapor withdrawal type tank. This fire pit is designed to operate on propane gas only. The 20 lb LP cylinder used with this fire pit must conform to the following requirements:

- Type 1 Connections
- Diameter - 12" / 31.1cm
- Height - 18.25" / 46cm
- 9.07 kg / 20 lb LPG capacity or 21.6 kg / 47.6 lb water capacity

The gas cylinder used must include a collar to protect the cylinder valve. The cylinder supply system must be arranged for vapor withdrawal.

Follow the instructions stated on gas cylinder tanks when filling or transporting tanks. Failure to do so could result in problems relating to overfilling, excessive venting release of gas and to regulator freezing. Never fill the cylinder more than 80 percent full.

⚠ CAUTION

In the connection process, the HVR side of the connection will seal on the back check in the valve, resulting in a slight resistance. The connection requires about one-half to three quarters additional turn to complete connection. Any fuel supply cylinder used must be constructed and marked in accordance with specifications for propane cylinders of the U.S. Department of Transportation (DOT)CFR 49 or CAN/CSA B339.

Do not allow dirt or foreign material to get into or onto tank connection when it is not attached to the fuel supply system. Use the protective cap provided. Place dust cap on cylinder valve outlet whenever the cylinder is not in use. Only install the type of dust cap on the cylinder valve outlet that is provided with the cylinder valve. Other types of caps or plugs may result in leakage of propane. Cylinders must be filled before initial use. All handling, transport, filling and storage of LP gas cylinders must be in accordance with NFPA 58 Storage and Handling of Liquid Petroleum Gasses, or CAN/CSA b149.2 Propane Installation Code.

⚠ CAUTION

The gas pressure regulator provided with this appliance must be used. This regulator is set for an outlet pressure of 11" H2O. Replacement pressure regulators and hose assemblies must be those specified by the fire pit manufacturer. See rating sticker on side of fire pit for regulator model number. The regulator/hose assembly should be handled carefully to prevent contamination by foreign objects and dirt. The assembly should be inspected before use and any dirt or contamination should be wiped off. The hose assembly must be replaced prior to the appliance being used if there is any evidence of excessive abrasion or wear, or if the hose is damaged. In order to insure proper operation, any replacement of the regulator assembly must be with parts authorized by manufacturer. Valve/pressure regulators are factory set to the correct operating pressures. No attempts should be made to adjust these settings.

Cylinders must be suitably tied down during transport. Do not place any other items on top of cylinders at any time.

Cylinders are not to be exposed to excessive temperatures or high heat. Refer to the data plate for model identification. Units are factory equipped for use on only one type of fuel. These units cannot be, and should not be used on other types of fuels. Doing so can cause severe damage to the unit and the installation area and the added risk of serious injury. Any attempt to operate this product on fuels for which it is not designed voids the manufacturer's warranty.

This unit is not to be utilized with a non-self-contained LP-gas supply system.

⚠ WARNING

Appliance must be leak checked outdoors in well-ventilated area, away from ignition sources such as gas fired or electrical appliances. During leak test, keep appliance away from open flames or sparks.

LEAK TESTING

1. Turn all control knob(s) to OFF.
2. Be sure regulator is tightly connected to LP tank.
3. Slowly open LP tank valve by turning hand wheel counter clockwise. If you hear a rushing sound, turn gas off immediately. There is a major leak at the connection. Correct the leak before proceeding.

4. Brush 50/50 soap and water solution onto indicated connections shown.



5. If “growing” bubbles appear, there is a leak. Close LP tank valve immediately and retighten connections. If leaks cannot be stopped, do not try to repair. Call for replacement parts. Order new parts by giving the serial number, model number and name of items needed to the Service Center at 1-435-752-3922.
6. Always close LP tank valve after performing tank leak test by turning hand wheel clockwise.

⚠ WARNING

- Do not use appliance until leak checked.
- If you cannot stop a gas leak, immediately close LP tank valve and call LP gas supplier or your fire department!

HOSE CHECK

- Before each use, check to see if hoses are cut or worn. Replace damaged hose assembly before using appliance. Use only valve/hose/regulator specified by manufacturer. See product sheet for hose & regulator information.

CHECKING FOR LEAKS

1. After all connections are completed, check all connections and fittings for leaks with a soap solution.
2. With all valves closed, apply the leak check solution (50/50 mix of dish washing soap detergent and water) to all gas carrying connections and fittings.
3. Open tank valve. Presence of bubbles at areas of wet solution indicates a gas leak. If leaks are detected or you smell or hear gas, shut off the valve and repair the leak or replace the defective part.

Do not use the fire pit until all leaks are corrected.

⚠ CAUTION

The burner must be inspected before each use of the appliance. If it is evident that the burner is damaged it must be replaced before the appliance is put into use. The burner must be replaced only by factory authorized parts as specified by the manufacturer.

OPERATING INSTRUCTIONS

Lighting Procedures

1. Check all connections for leaks using the “soapy water” test.
2. Check for any blockage to the venturi tube or burner. Remove any foreign objects or matter.
3. Be sure the burner control knob is “OFF”.

4. Open the LP cylinder valve ONLY 1-1/2 turns by turning counterclockwise.
5. Insert a long-nose gas lighter next to the burner, making sure it sits over the burner. Open the valve next to the burner by turning the lever to the ON position. If the burner does not light within 4 or 5 seconds, turn the control knob off, wait 5 minutes, and repeat the process.

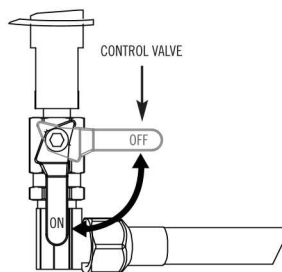

⚠ CAUTION

The fire pit can become very hot while in use. Do not touch any portion of the fire pit except for the control knob next to the regulator. It may be necessary to use protective gloves.

SHUTTING THE FIRE PIT OFF

Turn the control knob off and the burner flame should then go out. Turn off the LP cylinder valve by turning the knob clockwise until it stops. Follow instructions in this manual for proper storage procedures and the important warnings and safe guards on pages. When an LP tank is not connected, and to help prevent dirt or other foreign particles from clogging the HVR, hang the end of the HVR hose from the outer ring.

Inspect the flame at the burner to ensure a proper flame.

To protect your fire pit from weather, always keep your fire pit covered while not in use. The cover must be removed and stored safely away from the fire pit when the fire pit is in use. If the fire pit is not in use, the gas must be turned off at the supply cylinder and the cylinder should be disconnected from the fire pit. Storage of the fire pit indoors is only permissible if the cylinder is disconnected and removed from the fire pit.

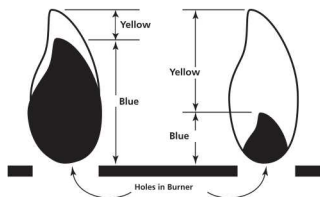

CLEANING

Clean the stand of the fire pit using hot soapy water.

High temperature spray paint can be used to touch up any scratches in the paint. Use a wire brush to remove any loose paint before touching up. Make sure to dry thoroughly before use. The rocks can be removed from the fire pit and cleaned using soapy water or sprayed off using a hose sprayer. The outside of the burner may be wiped clean using soapy water. A pipe cleaner can be used to remove any spider webs from the venturi tube.

LIMITED WARRANTY

Camp Chef No-Hassle Warranty

Here at Camp Chef we stand by our products and take pride in our customer service. Because of this, your new Camp Chef product comes with a No-Hassle Warranty. We warrant that our products will be free from defects in all materials and workmanship (excluding paint and finish) for the Warranty Coverage Period described below. This warranty is extended only to the original consumer purchaser. During the Warranty Coverage Period, we will (at our sole option) replace any defective part or product covered by this warranty when provided with proof of purchase. The replacement will be without charge.

Required Maintenance:

Clean your product after each use to maintain its finish and prolong its lifespan. Wipe away all grease and ashes. Keep metal products free of moisture, salts, acids and harsh fluctuations in temperature. Product paint and other finishes are not covered by this warranty. The exterior finish of the product will wear down over time.

Coverage Details:

Warranty does not cover normal wear of parts or damage caused by misuse, abuse, overheating and alteration. No alterations are covered in this warranty. Camp Chef is not responsible for any loss due to neglectful operation. Furthermore, this warranty does not cover products damaged or rendered defective due to accident, misuse, abuse, modification, water damage, neglect, improper handling or storage, improper maintenance or installation, incorporation of third party components or exposure to weather, natural disasters such as earthquakes, hurricanes, tornadoes, floods, lightning, fires, or failure to follow instructions for use.

ANY WARRANTIES IMPLIED BY LAW SHALL IN NO EVENT EXTEND BEYOND DURATION OF THIS EXPRESS WARRANTY. Some States do not allow limitations on how long an implied warranty lasts, so the above limitation may not apply to you. REPAIR OR REPLACEMENT AS PROVIDED HEREIN IS YOUR EXCLUSIVE REMEDY FOR ANY DEFECTIVE PRODUCT. IN NO EVENT SHALL WE BE LIABLE FOR ANY SPECIAL, INCIDENTAL OR CONSEQUENTIAL DAMAGES OF ANY KIND ARISING OUT OF THE PURCHASE OR USE OF THIS PRODUCT, WHETHER BASED UPON CONTRACT, TORT, STATUTE OR OTHERWISE. Some states do not allow the exclusion or limitation of incidental or consequential damages, so the above limitation or exclusion may not apply to you. This warranty gives you specific legal rights, and you may also have other rights which vary from State to State.

Please keep all original sales receipts from the authorized dealer. Proof of purchase is required to obtain warranty services. Any parts or products returned without written authorization will be discarded without notice.

To obtain warranty services submit a warranty request at www.campchef.com/warranty-information, email: warranty@campchef.com or call (800) 650-2433. Our English speaking Product Specialists are happy to help, Monday-Friday 7 AM – 5 PM MST.

Warranty applies to the United States and Canada.

WARRANTY COVERAGE PERIODS

Pellet Grills	3 years from purchase date
Stoves	1 year from purchase date
Fire Pits	1 year from purchase date
Water Heaters	1 year from purchase date
Movie Screens	1 year from purchase date
All other items & accessories	90 days from purchase date



www.CampChef.com | 1.800.650.2433 • Camp Chef is a registered trademark of Logan Outdoor Products
©2019 • 3985 N 75 W, Hyde Park, UT 84318, USA • Made in China 0219_GCLOG_Instructions