

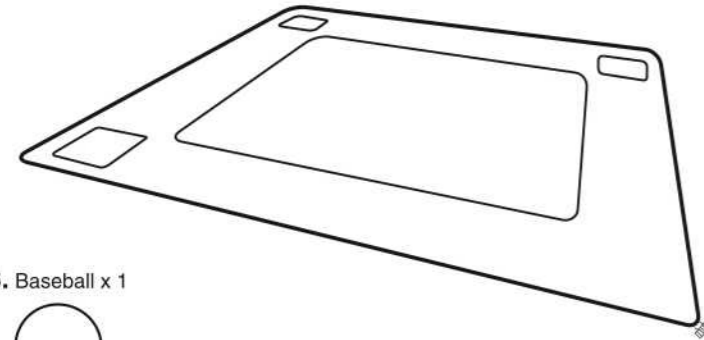

# HOME RUN SPLASH BASEBALL SLIDE™

1. Baseball Diamond Water Slide x 1



2. Baseball Bat x 1



3. Baseball x 1



4. Inflatable Home Plate x 1

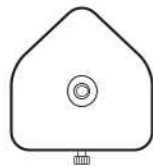

5. Water Spray Nozzle x 1

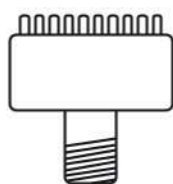

6. Water Tubes x 1



7. Repair Patch x 1

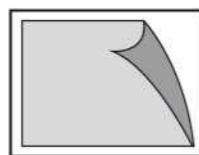

## IMPORTANT SAFETY INSTRUCTIONS.

PLEASE READ THESE INSTRUCTIONS THOROUGHLY BEFORE SETUP AND USE.

KEEP THESE INSTRUCTIONS IN A SAFE PLACE FOR FUTURE REFERENCE.

FOR AGES 5-12

ADULT SET UP IS REQUIRED.

DO NOT STAND, KNEEL, WALK OR RUN ON THE SLIDE SURFACE.



## Safety Information

### WARNING!

To avoid the risk of serious injury or death:

- Adult supervision required.
- Adult assembly required.
- Setup should be done a safe distance away from fences, garages, houses, overhanging branches, laundry lines or overhanging electrical wires.
- Use on a flat, level lawn only. Do not use on pavement or other hard surfaces. Lawn should be free of rocks, bumps, depressions, sticks or other sharp objects.
- Because of their larger size, older children and adults risk spine, neck, head or other life-threatening injuries from using this slide.
- Reckless use, misuse or abuse of this slide may cause serious, even fatal injury.
- Read all instructions before using this product.
- Correctly follow all instructions and safety requirements shown in this manual; otherwise injury or death, especially for children, could result.
- All inflatables are temperature sensitive, therefore never unfold or inflate in temperatures below 50 °F (10 °C).
- NOT FOR ADULT USE. NOT FOR CHILDREN OVER 12 OR UNDER 5 YEARS OF AGE. THIS PRODUCT IS NOT FOR USE BY ANYONE WEIGHING OVER 110 lb (50 kg).

While every attempt is made to embody the highest degree of protection in all equipment, we cannot guarantee freedom from injury. The user assumes all risk of injury resulting from use. All merchandise is sold on this condition, which no representative of the company can waive or change.

### IMPORTANT WATER PRESSURE AND OPERATING INFORMATION

After connecting the hose connector to your garden hose, TURN ON WATER SLOWLY and adjust the water pressure accordingly. Water pressure can vary dramatically between cities. Please read the following for answers to common questions.



Scan code for a video of step-by-step assembly instructions

### AREAS OF LOW WATER PRESSURE

- For maximum performance, it is recommended to use a 5/8 in (1.6 cm) diameter garden hose.
- If water does not arch on the product / spray properly, it is usually due to low water pressure. Make sure the water is on all the way. As long as the slides are getting wet, it will be fun to use.
- Long hose reduces water pressure: The longer the hose, the farther the water travels from the faucet, thus reducing water pressure. In areas of low water pressure, this could affect the performance of the water slide. Try using a shorter hose if you have one.

### AREAS OF HIGH WATER PRESSURE

- If water arches / sprays over the product, adjust the faucet to lower the water pressure. It is important that the water lands on the product to keep it wet and slick.

### MAINTENANCE OF PRODUCT

1. Check the product at regular intervals for holes, tears or other damage. DO NOT use a damaged product. Use of a damaged product could result in serious injury or death.
2. In addition to checking the product at regular intervals, be sure to complete a thorough check of the entire product at the beginning of each season or series of use.
3. If any components of the product are damaged or have deteriorated, discontinue use and contact the manufacturer.

### REPAIR PATCH INSTRUCTIONS

For your convenience, a repair patch has been included to repair holes in the inflatable section.

Do not use the patch for holes or rips on the seam.

In the event of an accidental puncture, cut out a suitably sized patch, making sure you round the corners of your repair patch to avoid peeling. Make sure the area to be patched is clean and dry. Press patch firmly over the puncture. Do not inflate for 20 minutes.

The repair patch should be applied by an adult.

## Setup Instructions

1.

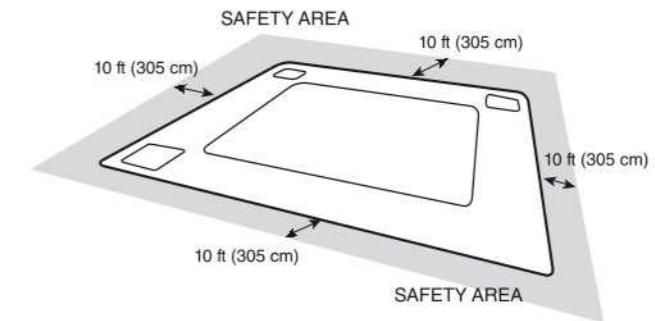

2.



3.

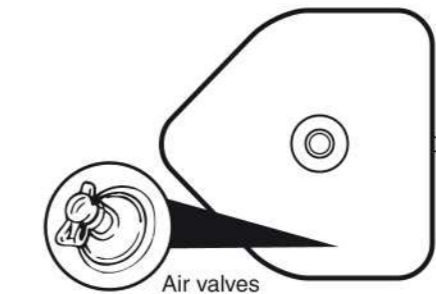

4.

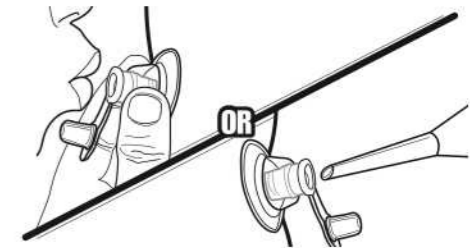

1. **PLACEMENT DIAGRAM:** Use on a flat, level lawn only, not on pavement or other hard surfaces. Lawn should be free of rocks, bumps, depressions, sticks, etc. This product should be setup in a location that has a minimum distance of 10 ft (305 cm) away from any freestanding structures or obstructions including: houses, garages, fences, trees, playground equipment and large rocks.

2. Roll out this product. Inspect for holes, tears or other damage.

3. Unplug the air valves to inflate this product with AIR.

**NOTE:** For easy air inflation, use a manual air pump designed specifically for plastic inflatables.

4. **BY MOUTH:** Squeeze the base of the valve, causing the inner flap to open before inflating.

**BY PUMP:** Insert air pump nozzle into the valve. The air pump nozzle should be inserted deep enough to open the inner valve flap before inflating.

Do not over inflate the item. Once the item is completely inflated, then insert the air valve plug to seal it shut.

**NOTE:** Fill the product with air until it is firm and solid. If there is any straining at the seams, the item is over inflated. If any seam begins to strain, immediately stop inflation and release air to reduce the pressure until all signs of stress on the inflatable are gone. DO NOT use the product if there is straining at the seams. Use of an over-inflated item may result in serious injury, paralysis or death.

Inspect this product for rips, tears or punctures. Do not use if damaged.

## Setup Instructions

5.

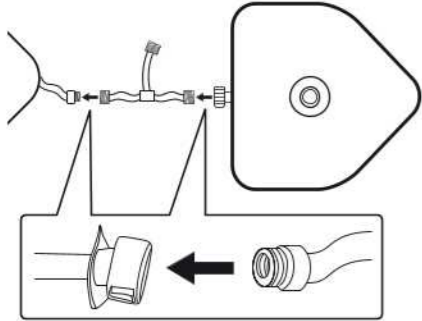

6.

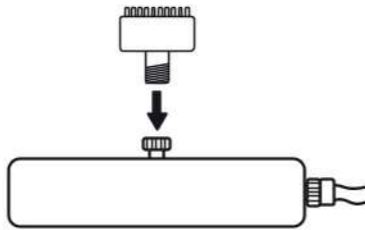

7.

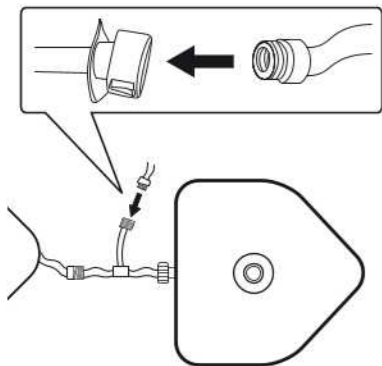

8-9.

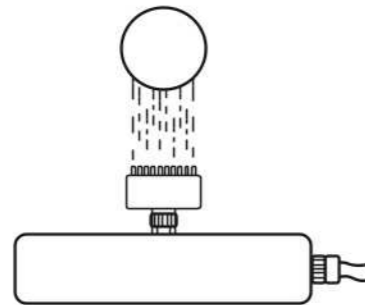

5. Connect the end of the water hose of the baseball slide to the inflatable Home Plate as shown above. Tighten until it cannot turn any further.

**NOTE:** Ensure kinks are removed from water hose.

6. Attach the included Water Spray Nozzle to the top of the Home Plate as shown above. Tighten until it cannot turn any further.

7. Before connecting the water slide to a water-source, use a standard garden hose to wet the entire slide surface. Then, attach the end of a garden hose to the hose connector on the water tube. Turn the connector to tighten; tighten until it cannot turn any further. **TURN ON WATER SLOWLY.** Gradually increase the flow of water until a tunnel of water arches and lands on the slide, keeping the slide wet.

**NOTE:** Allow water flow for 2 minutes for the slide rail to fully fill with water and the water spray height to reach the useable height.

8. Adjust the water volume so the stream on the Home Plate is about 42 inches tall. Adjust and swivel the ball joint of the Water Spray Nozzle until the water stream shoots straight up in the air.

9. Gently place the included baseball directly on top of the Water Spray Nozzle. Make sure it is centered over the water stream before letting go. The ball will begin to spin and rise on the the water.

**NOTE:** To properly balance the ball, Home Plate must be fully inflated with the Water Spray Nozzle level so the water streams are vertically straight.

## Use Instructions

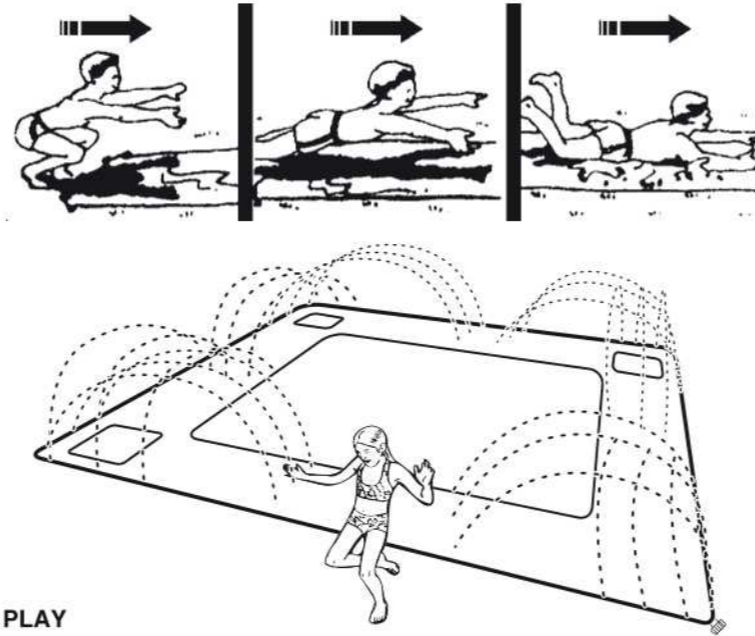

### HOW TO PLAY

Get ready to swing, slide and splash all summer long with the Home Run Splash Baseball Slide™! Balance the baseball on the sprays of the geyser-blasting home plate and take a swing. As the ball goes flying, slide from base to base as you splash the basemen before they tag you out. The water-sprinkling rails keep the sliding surface super slick as you slide your way to home plate. It'll be your new favorite summer pastime!

To Slide: Run & jump low to the ground from a crouching position. Land on your stomach, keeping your arms stretched out in front of you. **KEEP YOUR HEAD UP!**

When you are finished sliding, scoot off the slide and stand up on the grass. Walk back to the beginning of the slide and start again.

**WARNING!** Never stand, walk or run on the slide as you may slip and injure yourself.

### NOTE:

1. Competent adult setup and supervision is required at all times. Responsible adults should instruct children on the proper use of this product.
2. Remove all hard or sharp objects such as toys, buckles, keys, jewelry, watches, etc. from person and pockets.
3. **ALWAYS** slide down on stomach, facing forward with arms extended in front of you. **NEVER** slide on your knees, head or feet. **NEVER** dive head first.
4. No diving.
5. Be sure the slide surface is wet before sliding down.
6. Only one child should be on each slide lane surface at a time.
7. For long periods of play, move slide occasionally to prevent causing depressions in ground underneath.
8. Remove the product from the lawn when not in use and store properly to prevent the grass from yellowing or other damage.

## After Use and Storage

1.

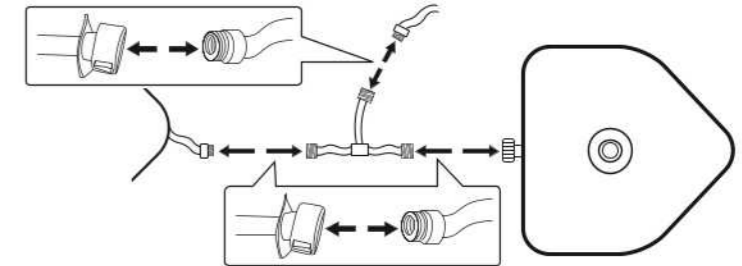

2.



3.



4.



1. Disconnect the garden hose from the hose connector.

2. Drain this product and let it dry.

3. **PUTTING AWAY YOUR PRODUCT:** Make sure the product and its accessories are free of dirt, leaves, sand, etc., before deflating.

4. Once the product is completely deflated and dry, carefully roll it up and store in a secure location away from children. Do not store it indoors or in a closed container until it is completely dry. The water slide should be rolled for storage to avoid creasing. Do not fold!

**NOTE:** Store this product in a secure place, away from children, to prevent suffocation.

BANZAI IS USED UNDER LICENSE BY FOCUS BRAND LTD.  
CONTENTS AND SPECIFICATIONS MAY VARY FROM THOSE ILLUSTRATED.

**Banzai®**

62767  
TANG RONG ROAD,  
CHANGPING, DONGGUAN, CHINA  
ALL RIGHTS RESERVED  
MADE IN CHINA  
www.toysinquiry.com