

ASSEMBLY, MAINTENANCE, & **USER MANUAL**

MODEL #SWBB1200 / SWBB1500

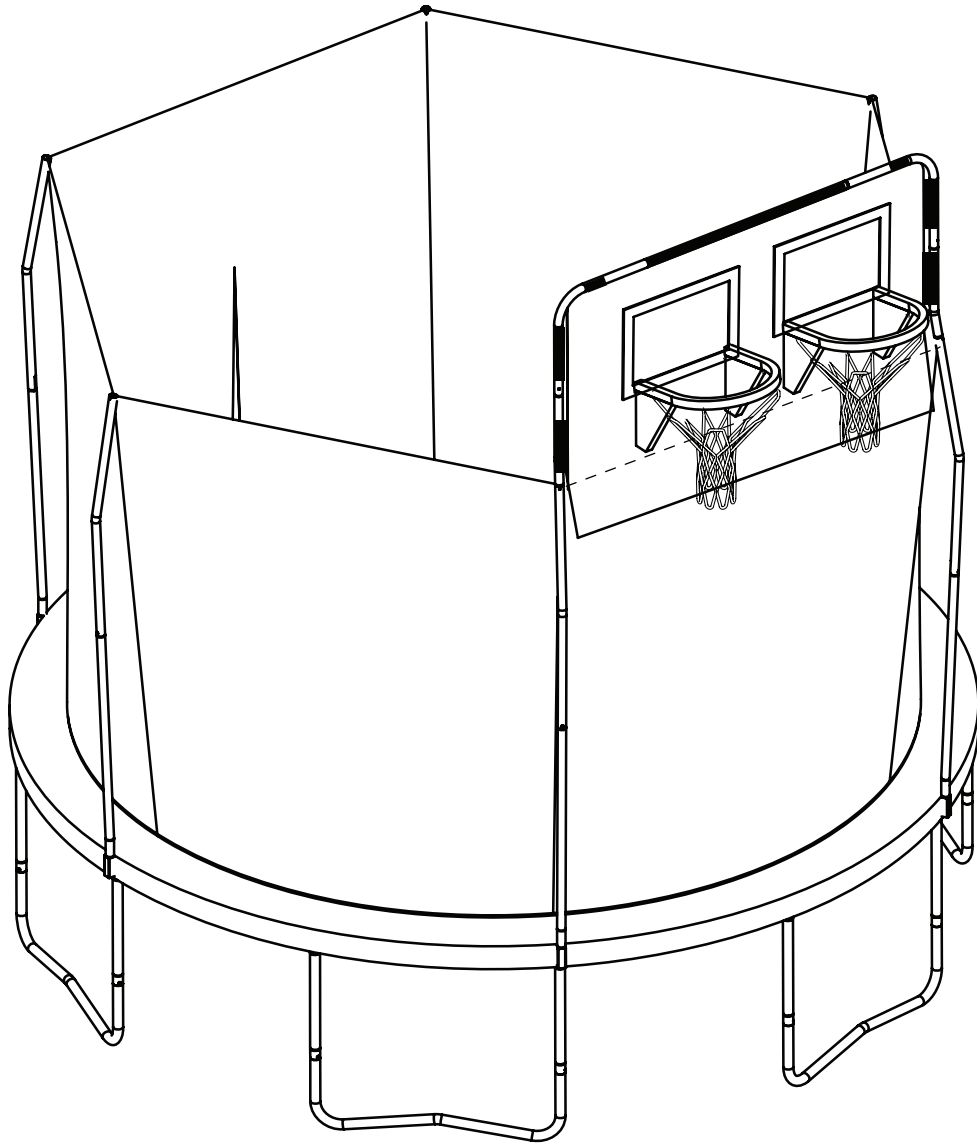

WARNING

Read all precautions and instructions in this manual before using this equipment. Save this manual for future reference.

SKYWALKER

TRAMPOLINES

Skywalker Holdings LLC
P.O. Box 574, Brigham City, UT 84302

TABLE OF CONTENTS

Part List.....	3
Part Identification - Trampoline.....	4-5
Part Identification - Games.....	6
Exploded Drawing.....	7-11
Limited Warranty.....	12



STOP EVERYTHING YOU'RE DOING AND REGISTER YOUR PRODUCT

Find our warranty registration online by typing in: www.skywalkertrampolines.com/registration/

You'll need to have the following information handy:

- Name
- Address
- Phone number
- Date of purchase
- Email address
- Trampoline model number
- Trampoline serial number
- Retailer the trampoline was purchased from

HEY WE'VE GOT SOMETHING REALLY IMPORTANT TO SAY

Skywalker Trampolines belongs to a family of brands focused on providing active products. Check us out online! We've got **assembly videos** (for those of you who prefer movies over books), **FAQs** (so you know you're not the only one who needs help), **additional products** (including trampolines, playground, sports, and fitness equipment), and most importantly, find us on social media! Because we want to be your friend. **We'd love to see how you are using our products!**



@skywalkertrampolines



skywalkertrampolines



@skywalker_trampolines



@swtrampolines



@swtrampolines



www.skywalkertrampolines.com



IMPORTANT

Trampolines and enclosures are susceptible to winds. Be sure to secure your trampoline and enclosure. Wind damage is not covered in the warranty of your trampoline.



WARNING

CHOKING HAZARD- Small parts not for children under 3 years.



WARNING

Adult assembly required.

PART LIST

Key No.	Qty.	Description
1	1	Middle Tube 1 with Foam
2	1	Middle Tube 2 with Foam
3	2	Corner Tube with Foam
4	2	Curved Tube with Foam
5	1	Backboard
6	2	Rim
7	2	Net
8	2	String (1.2m)
9	4	Support Block
10	6	Screw (2 spare parts)
11	2	Bolt
12	4	M5 Washer
13	2	M5 Nut
14	2	Basketball
15	3	String (0.5m)
16	1	Screw driver
17	1	Wrench

ORDERING REPLACEMENT PARTS

We get it, sometimes things happen. But the fun shouldn't stop just because you need a new bolt or screw! To order replacement parts, check out our website at: www.skywalkertrampolines.com or call our toll-free Customer Care Hotline at 1-866-603-Jump (5867), Monday - Thursday, 8 a.m. until 5 p.m. and Friday, 8 a.m. until 3 p.m. Mountain Time (excluding holidays).

Our customer service team will ask you a few questions in order to get the replacement part sent out as soon as possible. We're not trying to complicate your life, we promise.

When calling, make sure to have the following information ready:

- The model # of the product (see the front cover of this manual)
- The key # and description of the part (see the part list above)
- The quantity needed (only you know the answer to that one!)

BEFORE YOU BEGIN

Thanks for choosing Skywalker Trampolines! We're just as excited as you are to help your family live an active (but most importantly **FUN**) lifestyle. This model is one of our favorites, and we're confident you'll love it too. To make things easier for you, we've listed important information that you (and your little outdoor adventurers) need to know. Make sure you brush up on the warnings, instructions, assembly, maintenance, and use of your new product because there will be a pop quiz at the end! (Okay, not **REALLY**, but if you're still reading this, props to you! You're awesome).

PART IDENTIFICATION - GAMES

Before you begin, take a look at the drawings below to make sure you have all the parts! The numbers in the squares to the left (key numbers) will help you identify the parts during assembly.

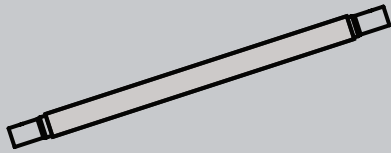

1 Middle Tube 1
with Foam (x1)

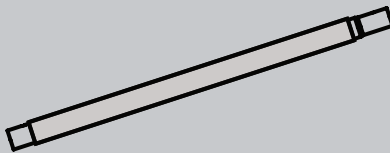

2 Middle Tube 2
with Foam (x1)

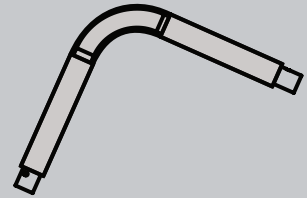

3 Corner Tube
with Foam (x2)

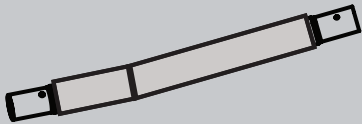

4 Curved Tube
with Foam (x2)

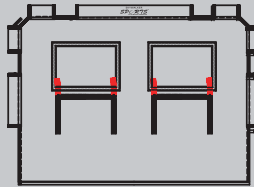

5 Backboard (x1)

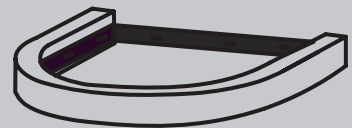

6 Rim (x2)

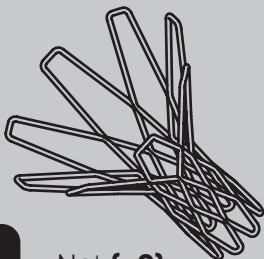

7 Net (x2)



8 String (1.2m) (x2)

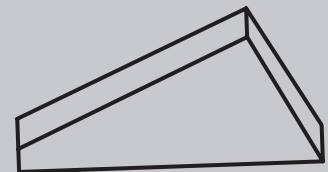

9 Support Block (x4)

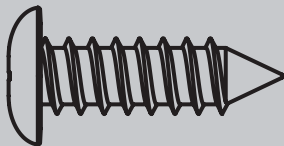

10 Self-tapping
Screw (x6)

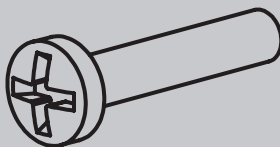

11-1 M5x38mm Bolt (x2)

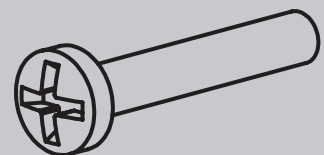

11-2 M5x44mm Bolt (x2)

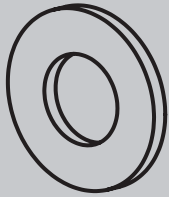

12

M5 Washer (x4)

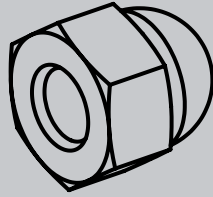

13

M5 Nut (x2)

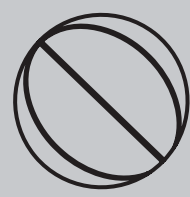

14

Basketball (x2)



15

String (0.5m) (x3)



16

Screw Driver (x1)

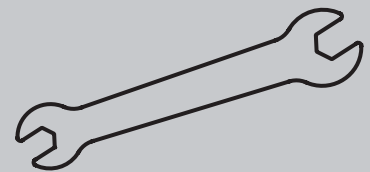

17

Wrench (x1)

EXPLODED DRAWING

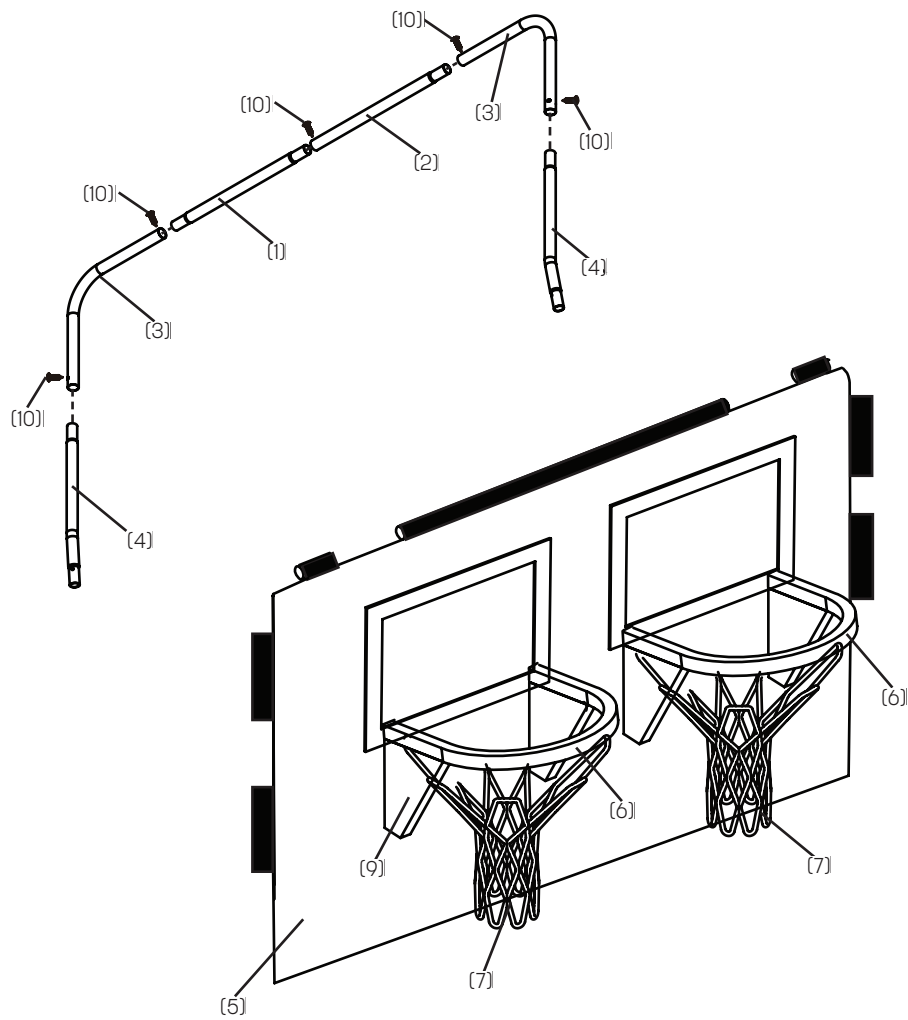

ASSEMBLY

STEP 1

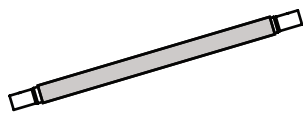

1 Middle Tube 1 with Foam (x1)

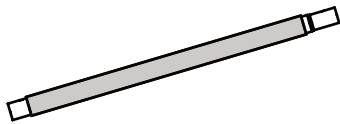

2 Middle Tube 2 with Foam (x1)

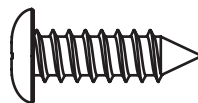

10 Self-tapping Screws (x1)

Insert the middle tube 1 with foam **(1)** into middle tube 2 with foam **(2)** as shown, and secure using one self-tapping screw **(10)**.

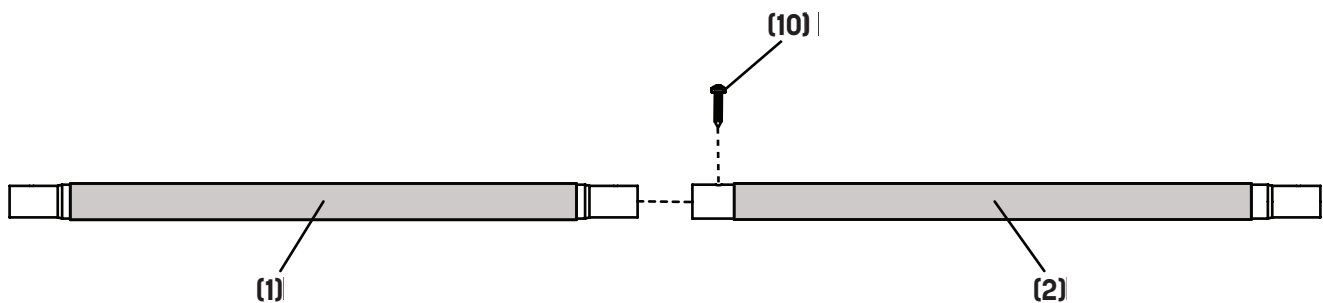

STEP 2

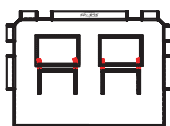

5 Backboard (x1)

Place the backboard **(5)** on the ground, and insert the assembled middle tube with foam into the top sleeve as shown.

You've got this!

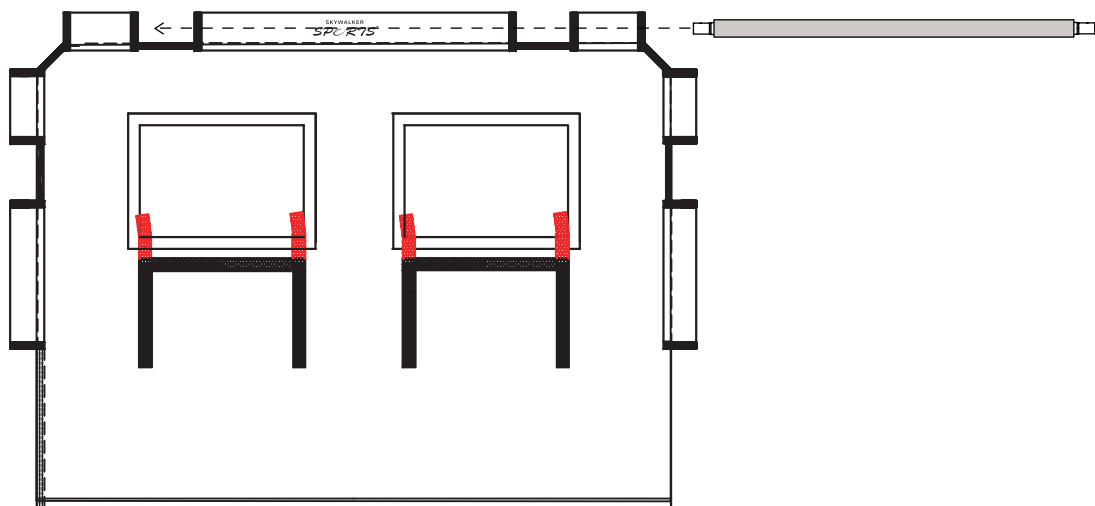

ASSEMBLY

STEP 3

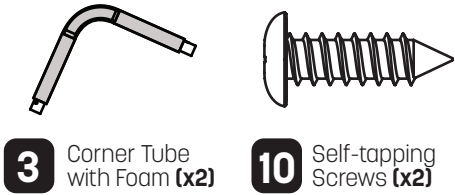

Insert the corner tubes with foam **(3)** into the sleeve as shown, and secure on each side using two self-tapping screws **(10)**.

Note: One end of the corner tube has one hole, and the other end has two holes. You are connecting the end with one hole.

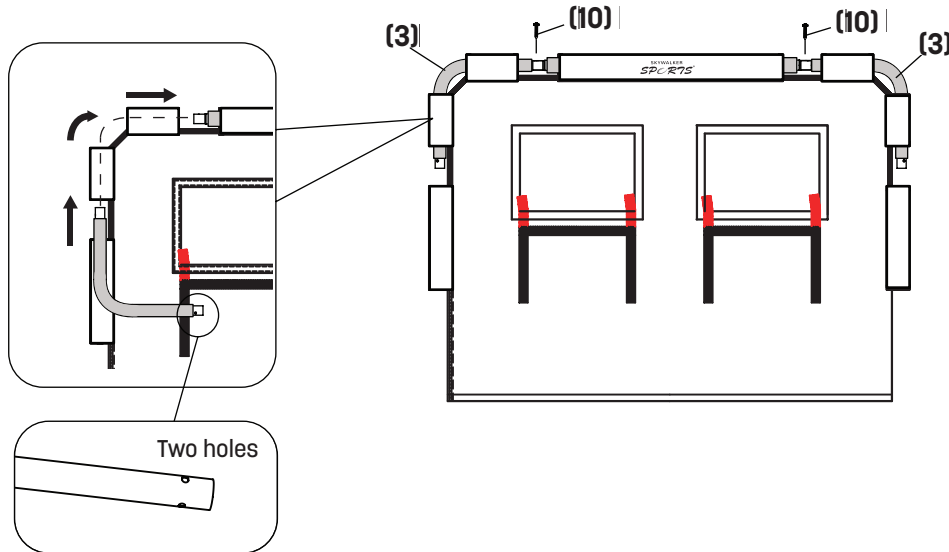

STEP 4

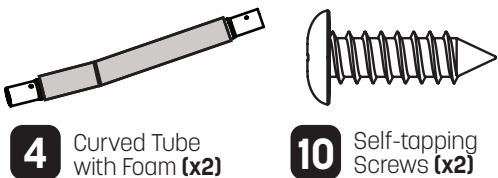

If you want the hoops to face inwards: Insert the curved tube **(4)** into the sleeve, making sure the bent side **curves toward the back**. Secure using two self-tapping screws **(10)**. **If you want the hoops to face outwards:** Insert the curved tube into the sleeve, making sure the bent side **curves towards the front**. Secure using two self-tapping screws.

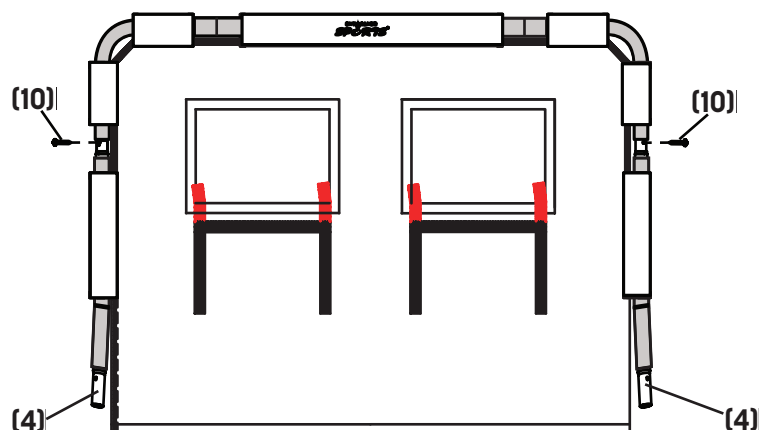
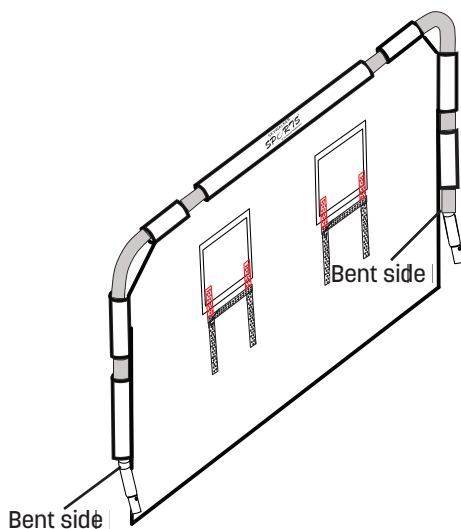

STEP 5

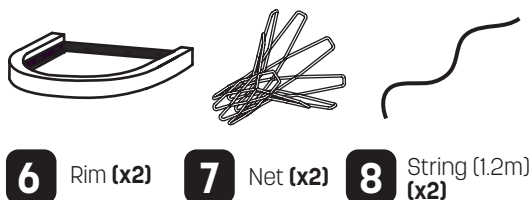

Take one end of the string **(8)** and tie a knot at the end. Begin threading the other end of the string through the left hole on the rim **(6)**. Weave the string in and out of the holes on the rim and the net **(7)** to attach completely. Make sure to regularly tighten the string. Once you've made it all the way around the rim, tie a knot at the end of the string to secure.

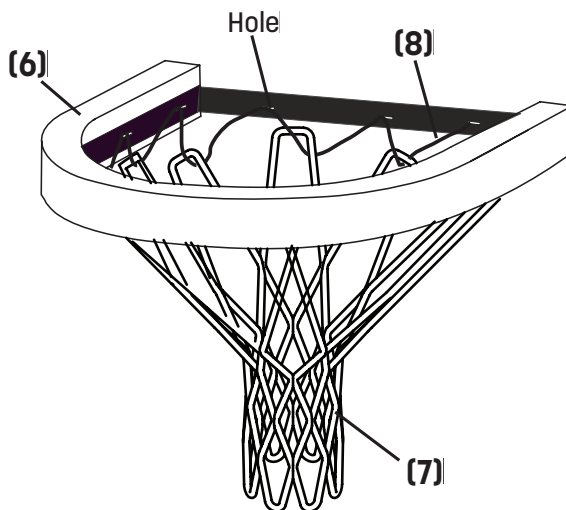

STEP 6

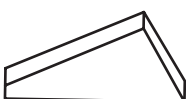

9 Support Block (x4)

Attach the 4 support blocks **(9)** to the backboard **(5)** using the provided velcro.

Then, attach the ring with net to the backboard. You're almost done!

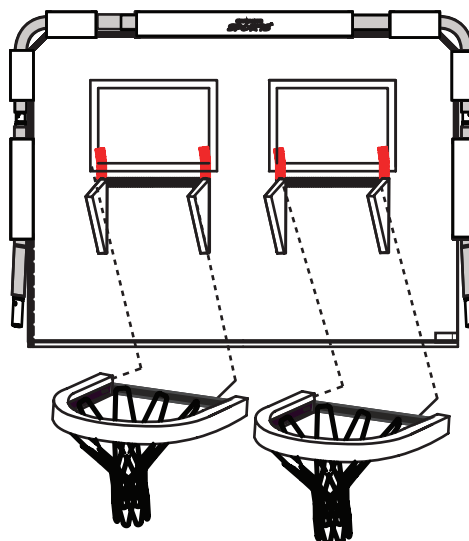
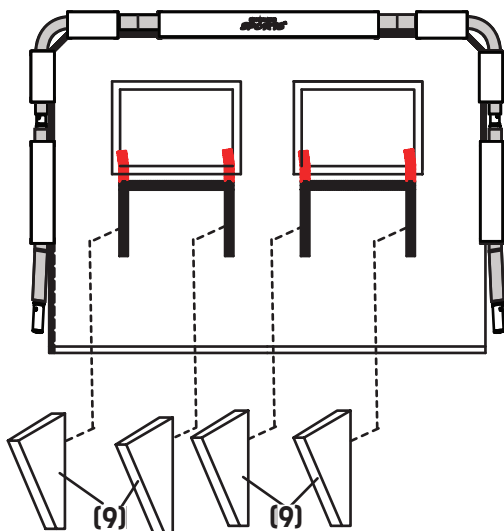

ASSEMBLY

STEP 7

To attach the game to your trampoline you will need to lower the two enclosure poles you will be mounting to. (Additional poles may also need to be lowered in order to release some of the tension from the enclosure net.) Remove the pole caps from the two chosen enclosure poles.

Helpful tip: When removing the enclosure poles, pull back on the middle of the poles!

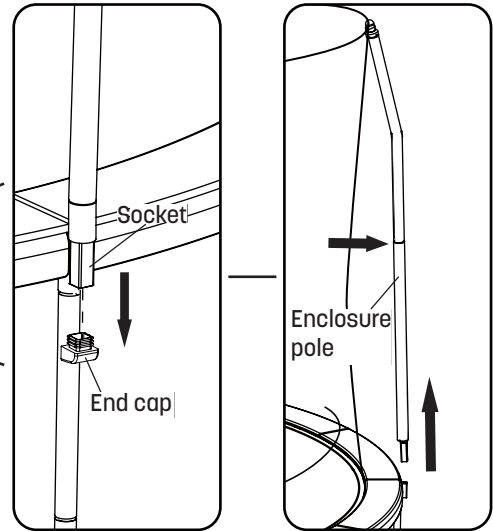
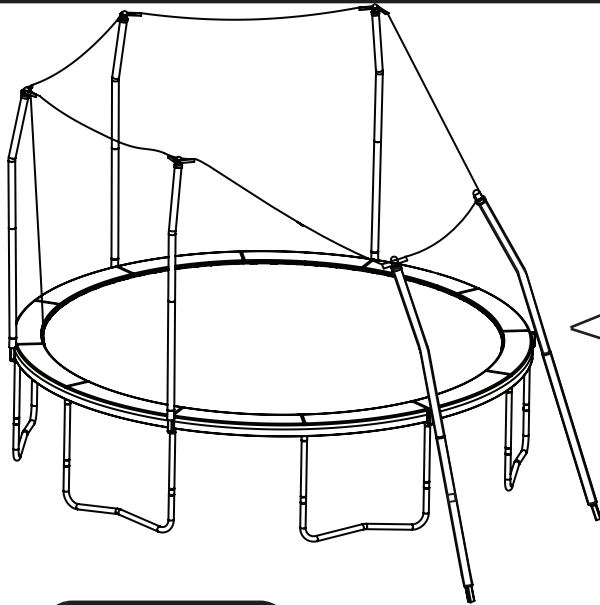

STEP 8



11 Bolt
(x2)

12 Washer
(x4)

13 Nut
(x2)

Slide the basketball hoop onto the upper tubes and align the holes of the upper poles, basketball hoop, and the enclosure net and attach together with the two bolts (11-1 or 11-2), four washers (12) and two nuts (13).

Note: Depending on the model of your trampoline the poles of the game may slide into the enclosure poles rather than onto. Attachment works both ways and will not change the assembly method.

Note: There are two size of bolts (11) for this step to accommodate varying models. Please choose the appropriate one.

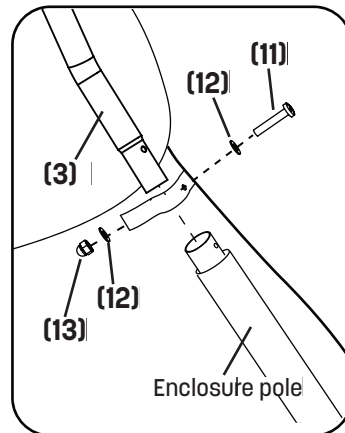
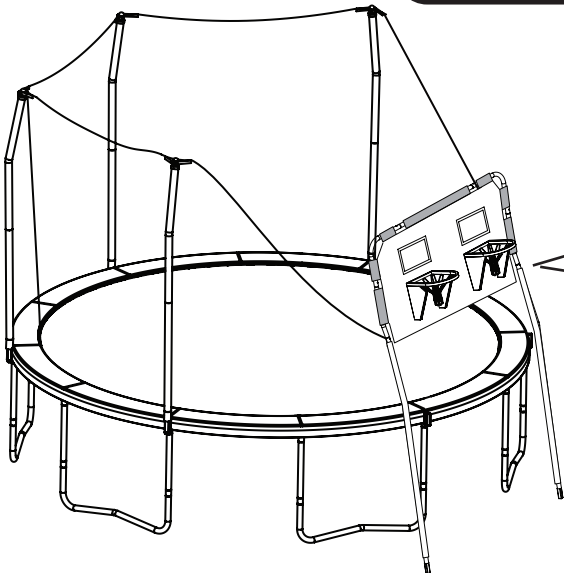

STEP 9

Now with two people (one on each side of the game) raise the enclosure poles together and place them in their T-sockets. If you have any other enclosure poles down, place them back up now as well.

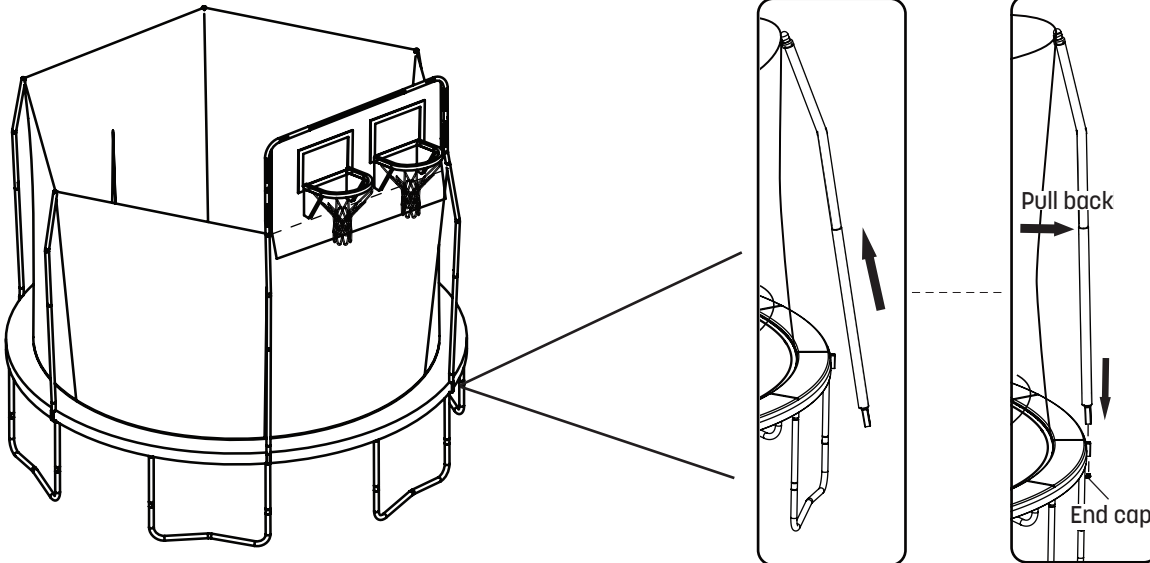

STEP 10



15 String (0.5m) (x3)

To secure the bottom of the game, slide the 3 pieces of string (0.5m) **(15)** through the netting of the game (one on each corner and one in the middle.)

Tie the strings to the poles and enclosure net as shown. **Note: If you tie the strings too tight... you might cut the foam!**

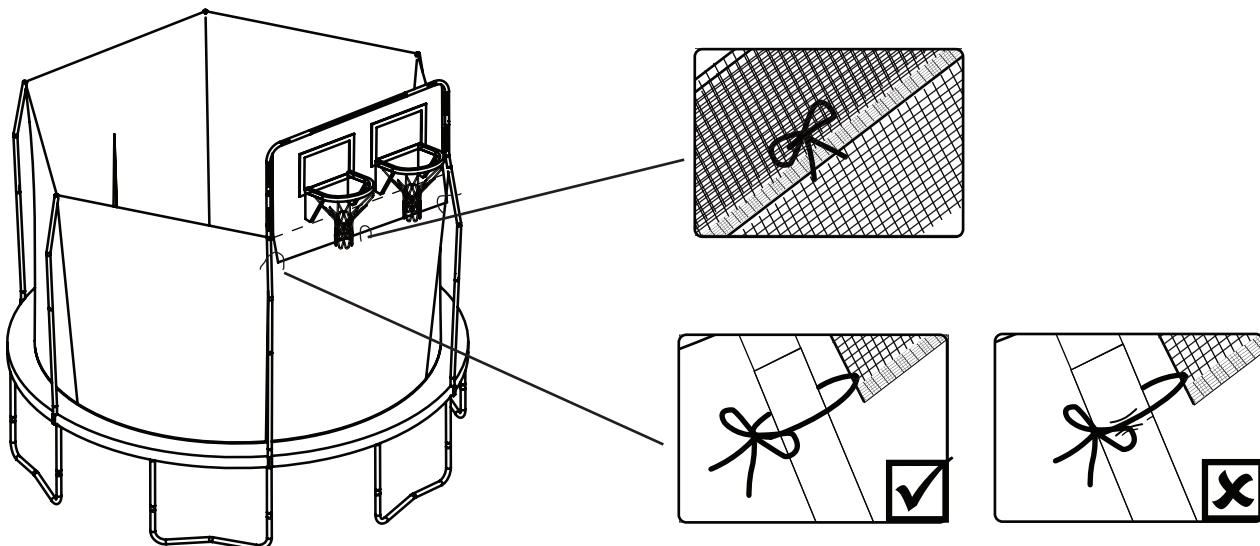

LIMITED WARRANTY

Skywalker Holdings, LLC warrants its products to be free from defects in material and workmanship under normal use and service conditions. **The steel frame is warranted for three (3) years after the date of purchase. All other parts are warranted for one (1) year after the date of purchase.** Warranty coverage extends only to the original retail purchaser from the date of original purchase. This warranty is only valid concerning products used for residential use. Products used for commercial use, such as schools and daycares, will not be covered.

WHAT IS NOT COVERED?



Weather Damage: The warranty does not cover damage due to the effects or acts of nature, such as earthquakes, wind, hurricanes, tornadoes, lightning, rain, fire, snow, excessive heat and cold conditions and/or sun damage. During the winter months the trampoline soft materials will need to be removed and stored in a dry place out of the snow. If left unprotected in the winter months, some components such as springs, jump mat, spring pad and enclosure, may become damaged, voiding this warranty.



Fading and Rust: Our products are fully galvanized. Skywalker does not warranty against rust or corrosion. Some areas may have higher air salt content, higher humidity, heavier rain and heavier snow. Skywalker does not warranty against fading. We suggest customers use a UV protectant on the frame pad to extend the life of the product.



Loss or damage to Product Due to: Loss or damage caused during shipping or caused by abuse, misuse, improper or abnormal usage or authorized repair are not covered by this warranty and may also void the warranty.



Unauthorized Replacement Parts: The warranty will become void if any defects or damages are associated with the use of unauthorized replacement parts. All replacement parts must be obtained from an authorized agent.



Assembly Service: The warranty does not cover acts or omissions provided by a third-party assembly service. It is the customer's responsibility to check all boxes and confirm all components are included and in their proper condition before installation occurs.

INSPECTION AND REPLACEMENT PARTS:

1. Your product SHOULD BE INSPECTED UPON UNPACKING AND SET UP AND THEREAFTER ON A REGULAR BASIS. WORN, DAMAGED OR BROKEN PARTS SHOULD BE REPLACED IMMEDIATELY AND BEFORE USE.
2. Call the Skywalker Trampoline Customer Service Department at 1-866-603-5867 to file a warranty claim. Be prepared to provide the following information: name, shipping address, a copy of your original sales receipt, a brief description of the problem and cause, model number and serial number. We may also ask for photos of the damaged/defective parts.
3. After reviewing your information and examining your photos, Skywalker Trampolines will make the determination if this part is covered by this warranty. If so, a replacement part will be sent to you.

NOTE: All requested information must be provided in order to review your warranty claim.

To order replacement parts for your product please visit www.skywalkertrampolines.com

Skywalker Holdings, LLC, PO Box 574, Brigham City, UT 84302 USA.

Printed in China © 2020 Skywalker Holdings, LLC

NOTE: SKYWALKER HOLDINGS, LLC IS NOT RESPONSIBLE OR LIABLE FOR INDIRECT, SPECIAL OR CONSEQUENTIAL DAMAGES ARISING OUT OF OR IN CONNECTION WITH THE USE OR PERFORMANCE OF THE PRODUCT OR OTHER DAMAGES WITH RESPECT TO ANY ECONOMIC LOSS, LOSS OF PROPERTY, LOSS OF REVENUE OR PROFITS, LOSS OF ENJOYMENT OR USE, COST OF REMOVAL, INSTALLATION OR OTHER CONSEQUENTIAL DAMAGES. SOME STATES DO NOT ALLOW THE EXCLUSION OR LIMITATION OF INCIDENTAL OR CONSEQUENTIAL DAMAGES. ACCORDINGLY, THE ABOVE LIMITATION MAY NOT APPLY TO YOU.

THE WARRANTY EXTENDED HEREUNDER IS IN LIEU OF ALL OTHER WARRANTIES AND ANY IMPLIED WARRANTY OF MERCHANTABILITY OR FITNESS FOR A PARTICULAR PURPOSE IS LIMITED IN ITS SCOPE AND DURATION TO THE TERMS SET FORTH HEREIN. SOME STATES OR COUNTRIES DO NOT ALLOW LIMITATIONS ON HOW LONG AN IMPLIED WARRANTY LASTS. ACCORDINGLY, THE ABOVE LIMITATION MAY NOT APPLY TO YOU. THIS WARRANTY GIVES YOU SPECIFIC LEGAL RIGHTS. YOU MAY ALSO HAVE OTHER RIGHTS WHICH VARY STATE TO STATE OR COUNTRY TO COUNTRY.

THIS WARRANTY IS VALID ONLY IN THE COUNTRY THE PRODUCT WAS PURCHASED.